

PG8720I

Sturm!
POWER • GAS • HAND • TOOLS

Sturm!
POWER • GAS • HAND • TOOLS

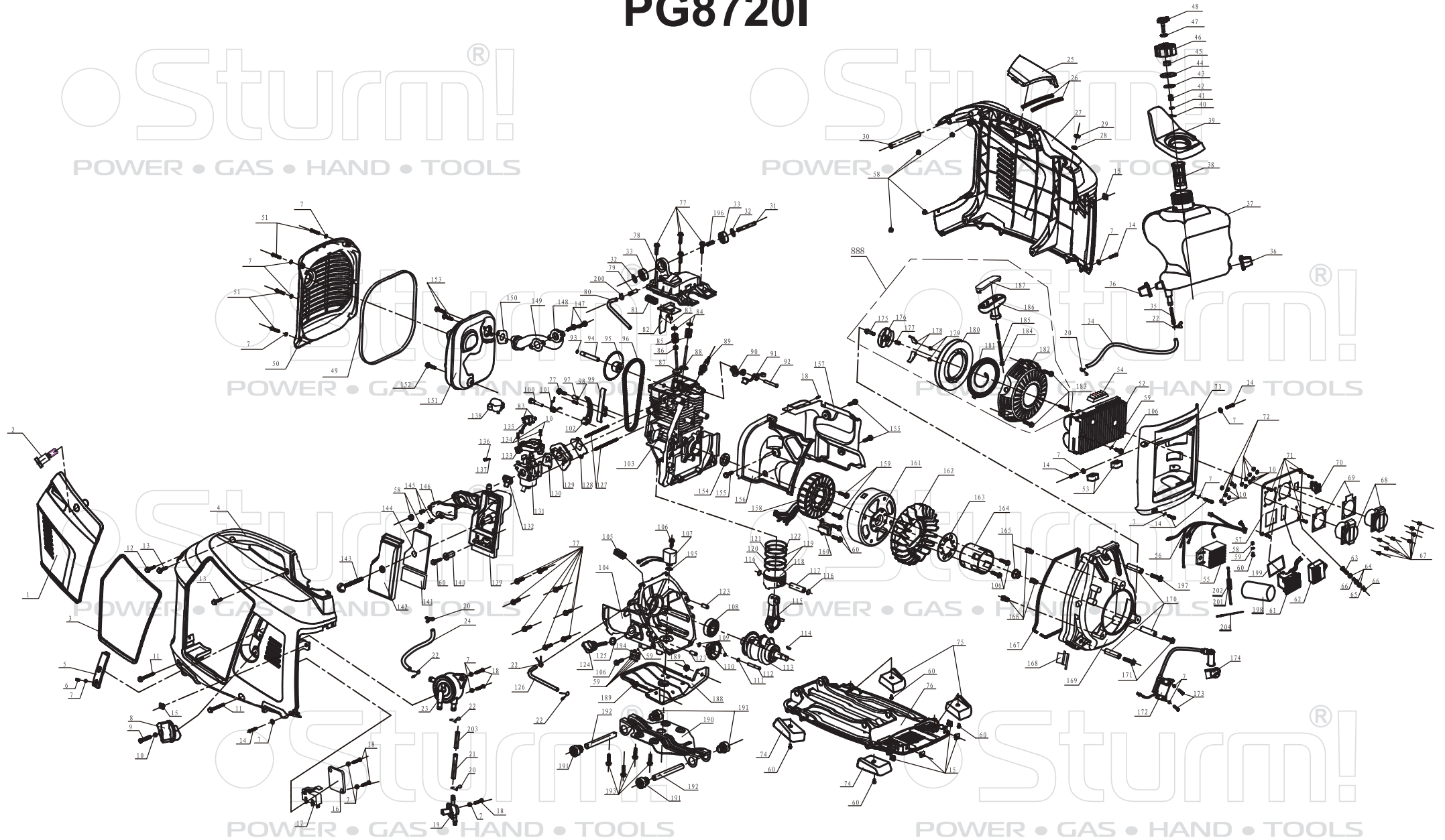

POWER • GAS • HAND • TOOLS

POWER • GAS • HAND • TOOLS

PG8720I

NO.	DESCRIPTION	NO.	DESCRIPTION	NO.	DESCRIPTION	NO.	DESCRIPTION	NO.	DESCRIPTION
1	MAINTENANCE COVER	43	WASHER $\Phi 6.5 \times \Phi 24 \times 1.4$	85	VALVE SPRING	127	BOLT M5 \times 115	169	BOLT M5 \times 115
2	MAINTENANCE COVER SCREW	44	FUEL TANK CAP SEAL	86	VALVE SEAL	128	INSULATING BOARD GASKET	170	INSULATING BOARD GASKET
3	SPONGE SEAL	45	FUEL TANK CAP FILTER	87	INTAKE VALVE	129	INTAKE SEAT	171	INTAKE SEAT
4	LEFT ENCLOSER SUBASSEMBLY	46	FUEL TANK CAP	88	EXHAUST VALVE	130	CARBURETOR GASKET	172	CARBURETOR GASKET
5	HANDLE SUPPORT	47	O-RING	89	SPARK PLUG	131	CARBURETOR	173	CARBURETOR
6	SCREW M5 \times 8	48	TANK CAP LEVER	90	INTAKE ROCKER SUBASSEMBLY	132	INTAKE PIPE GASKET	174	INTAKE PIPE GASKET
7	WASHER $\Phi 5$	49	MUFFLER COVER SEAL	91	EXHAUST ROCKER SUBASSEMBLY	133	GOVERNOR MOTOR BOTTOM HOOD	175	GOVERNOR MOTOR BOTTOM HOOD
8	SWITCH HANDLE	50	MUFFLER COVER	92	ROCKER SHAFT	134	SCREWM4 \times 10	176	SCREWM4 \times 10
9	SCREW M4 \times 16	51	SCREW M5 \times 14	93	O-RING $\Phi 2 \times 6$	135	GOVERNOR MOTOR	177	GOVERNOR MOTOR
10	WASHER $\Phi 4$	52	INVERTER	94	CAM SHAFT	136	GOVERNOR JOINT	178	GOVERNOR JOINT
11	BOLT M6 \times 145	53	INVERTER BOTTOM SUPPORT	95	CAM SUBASSEMBLY	137	GOVERNOR DAMPING SPRING	179	GOVERNOR DAMPING SPRING
12	BOLT M6 \times 100	54	FUEL TANK ABSORBER	96	TIMING CHAIN	138	GOVERNOR MOTOR TOP HOOD	180	GOVERNOR MOTOR TOP HOOD
13	BOLT M6 \times 30	55	BRIDGE RECTIFIER	97	SUBSIDIARY LEAD BAR SLEEVE	139	AIR CLEANER BODY	181	AIR CLEANER BODY
14	SCREW M5 \times 20	56	INTERNAL WIRE ASSEMBLY	98	LOCATING PIN $\Phi 6 \times 15$	140	AIR CLEANER BODY NESTING	182	AIR CLEANER BODY NESTING
15	NUT M5	57	PANEL	99	SUBSIDIARY LEAD BAR	141	AIR CLEANER FILTER	183	AIR CLEANER FILTER
16	ENGINE SWITCH COVER	58	NUT M5	100	TORSION SPRING PIN	142	AIR CLEANER BAFFLE	184	AIR CLEANER BAFFLE
17	ENGINE SWITCH	59	WASHER $\Phi 6$	101	LEAD BAR TORSION SPRING	143	SCREW M6 \times 16	185	SCREW M6 \times 16
18	TAPPING SCREW ST4.2 \times 12	60	BOLT M5 \times 12	102	MAIN CHAIN LEAD BAR	144	AIR CLEANER FILTER	186	AIR CLEANER FILTER
19	FUEL SWITCH	61	DC SOCKET	103	CYLINDER SUBASSEMBLY	145	INTAKE PIPE COVER	187	INTAKE PIPE COVER
20	CLIP $\Phi 7 \times 0.8$	62	IGNITION	104	CRANKCASE	146	INTAKE PIPE TOP HOOD	188	INTAKE PIPE TOP HOOD
21	FUEL TUBE $\Phi 4 \times \Phi 8$	63	SCREW M5 \times 16	105	OIL FILTER	147	BOLT M6 \times 22	189	BOLT M6 \times 22
22	CLIP $\Phi 9 \times 1.2$	64	WASHER $\Phi 5$	106	BOLT M6 \times 12	148	EXHAUST PIPE	190	EXHAUST PIPE
23	FUEL PUMP	65	SPRING LOCK WASHER $\Phi 5$	107	OIL LEVEL SENSOR	149	EXHAUST PIPE GASKET	191	EXHAUST PIPE GASKET
24	FUEL TUBE $\Phi 4 \times \Phi 8$	66	NUT M5	108	BEARING 6204/-P53	150	MUFFLER GASKET	192	MUFFLER GASKET
25	SPARK PLUG MAINTENANCE COVER	67	SCREW M4 \times 12	109	WASHER $\Phi 6$	151	MUFFLER	193	MUFFLER
26	SPARK PLUG MAINTENANCE COVER PACKING	68	AC SOCKET(CHOOSE)	110	WHISK OIL GEAR	152	BOLT M6 \times 65	194	BOLT M6 \times 65
27	RIGHT ENCLOSER SUBASSEMBLY	69	AC SOCKET MAT	111	GEAR SHAFT CLIP	153	BOLT M6 \times 45	195	BOLT M6 \times 45
28	WASHER $\Phi 13$	70	INTELLIGENT THROTTLE SWITCH	112	GEAR SHAFT	154	OIL SEAL $\Phi 20 \times 32 \times 6$	196	OIL SEAL $\Phi 20 \times 32 \times 6$
29	CIRCLIP FOR SHAFT	71	TAPPING SCREWST4.8 \times 16	113	CRANKSHAFT SUBASSEMBLY	155	BOLT M6 \times 10	197	BOLT M6 \times 10
30	ENGINE SUPPORT 1	72	NUT M4	114	SEMICIRCULAR KEY 3 \times 13	156	LEFT REFLECTING BOARD	198	LEFT REFLECTING BOARD
31	ENGINE SUPPORT 2	73	PANEL COVER	115	CONNECTION ROD	157	RIGHT REFLECTING BOARD	199	RIGHT REFLECTING BOARD
32	TOP DAMPING WASHER	74	LEFT ABSORBE FOOT	116	PISTON PIN CLIP	158	STATOR SUBASSEMBLY	200	STATOR SUBASSEMBLY
33	TOP ABSORBER	75	RIGHT ABSORBE FOOT	117	PISTON PIN	159	BOLT M5 \times 35	201	BOLT M5 \times 35
34	FUEL TUBE $\Phi 4 \times \Phi 8$	76	PEDESTAL	118	PISTON	160	IGNITON TRIGGER	202	IGNITON TRIGGER
35	FUEL FILTER	77	BOLT M6 \times 25	119	SPRING EXPANDER	161	ROTOR SUBASSEMBLY	203	ROTOR SUBASSEMBLY
36	FUEL TANK SUPPORT	78	CYLINDER HEAD COVER	120	FLAT TYPE OIL RING	162	COOLING FAN	204	COOLING FAN
37	FUEL TANK	79	PIPE JOINT	121	PISTON RING \boxtimes	163	ORIENTATION BOARD	888	STARTER ASSEMBLY(175+176.+187)
38	FILTER CUP	80	GAS CIRCLE PIPE $\Phi 7 \times \Phi 11$	122	PISTON RING \boxtimes	164	RATCH ROTARY TABLE		
39	OVERFLOW TROUGH	81	OIL FILTER	123	LOCATING PIN $\Phi 8 \times 20$	165	NUT M12 \times 1.25		
40	SPLIT PIN	82	VENTILATE BOARD SUBASSEMBLY	124	OIL DIPSTICK	166	COOLING HOOD NESTING		
41	WASHER $\Phi 5$	83	SCREW M3 \times 5	125	OIL DIPSTICK SEAL	167	COOLING HOOD COVER PACKING		
42	TANK CAP SPRING	84	VALVE RETAINER	126	PUMPING FUEL PIPE $\Phi 6 \times \Phi 10$	168	ROTOR TURN JACKET		

ST20110214