

CM1913

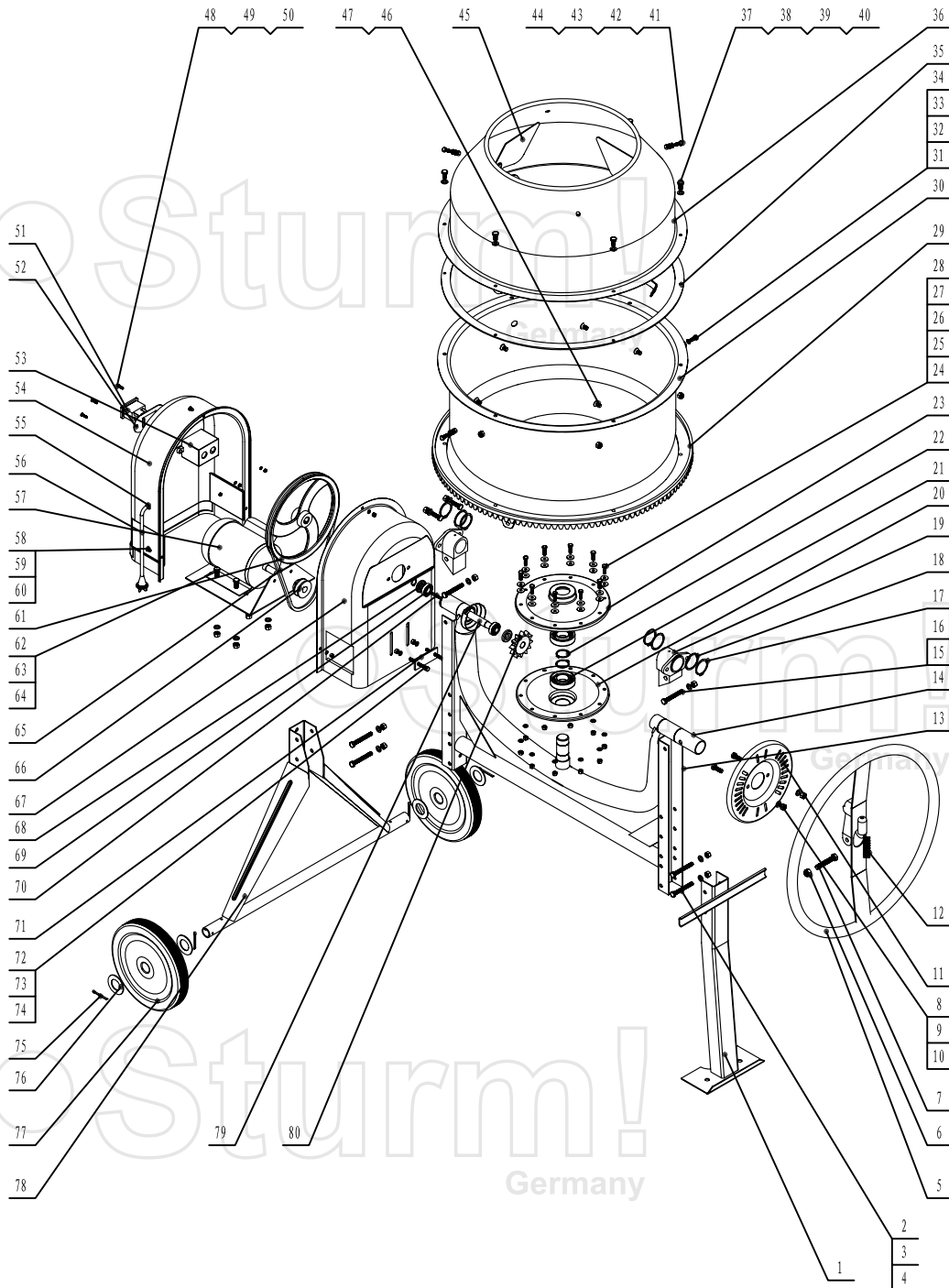

NO.	DESCRIPTION	NO.	DESCRIPTION
1	SUPPORT BRACKET	41	HEX BOLT
2	HEX BOLT	42	FLAT WASHER
3	WASHER	43	SET WASHER
4	HEX NUT	44	HEX NUT
5	DEGREE ADJUSTING WHEEL	45	MIXER
6	HEX NUT	46	SET SCREW
7	HEX BOLT	47	SET NUT
8	HEX BOLT	48	SET SCREW
9	WASHER	49	SET WASHER
10	HEX NUT	50	SET NUT
11	DEGREE ADJUSTING PLATE	51	SWITCH
12	COIL SPRING	52	PLATE
13	STAND	53	WIRE BOX
14	SUPPORT ARM	54	MOTOR BASE COVER(OUTER)
15	HEX BOLT	55	CORD SLEEVE
16	HEX NUT	56	POWER CORD
17	C-CLIP	57	MOTOR
18	FLAT WASHER	58	SET SCREW
19	IRON TUBE FIXTURE(R.H.)	59	SET WASHER
20	WASHER COVER(LOWER)	60	SET NUT
21	BALL BEARING	61	PULLEY(L)
22	C-CLIP	62	HEX BOLT
23	WASHER COVER(UPPER)	63	WASHER
24	HEX BOLT	64	HEX NUT
25	FLAT WASHER	65	V-BELT
26	WASHER	66	PULLEY(S)
27	SET WASHER	67	MOTOR BASE COVER(INNER)
28	HEX NUT	68	FLAT WASHER
29	RING GEAR	69	BALL BEARING
30	DRUM(LOWER)	70	KEY
31	HEX BOLT	71	STRAP
32	FLAT WASHER	72	HEX BOLT
33	SET WASHER	73	WASHER
34	HEX NUT	74	HEX NUT
35	CONNECTOR SEAL	75	PIN
36	DRUM(UPPER)	76	FLAT WASHER
37	HEX BOLT	77	WHEEL
38	FLAT WASHER	78	HINGE BRACKET
39	SET WASHER	79	SHAFT
40	HEX NUT	80	GEAR

RU61227-1