

# CC99222

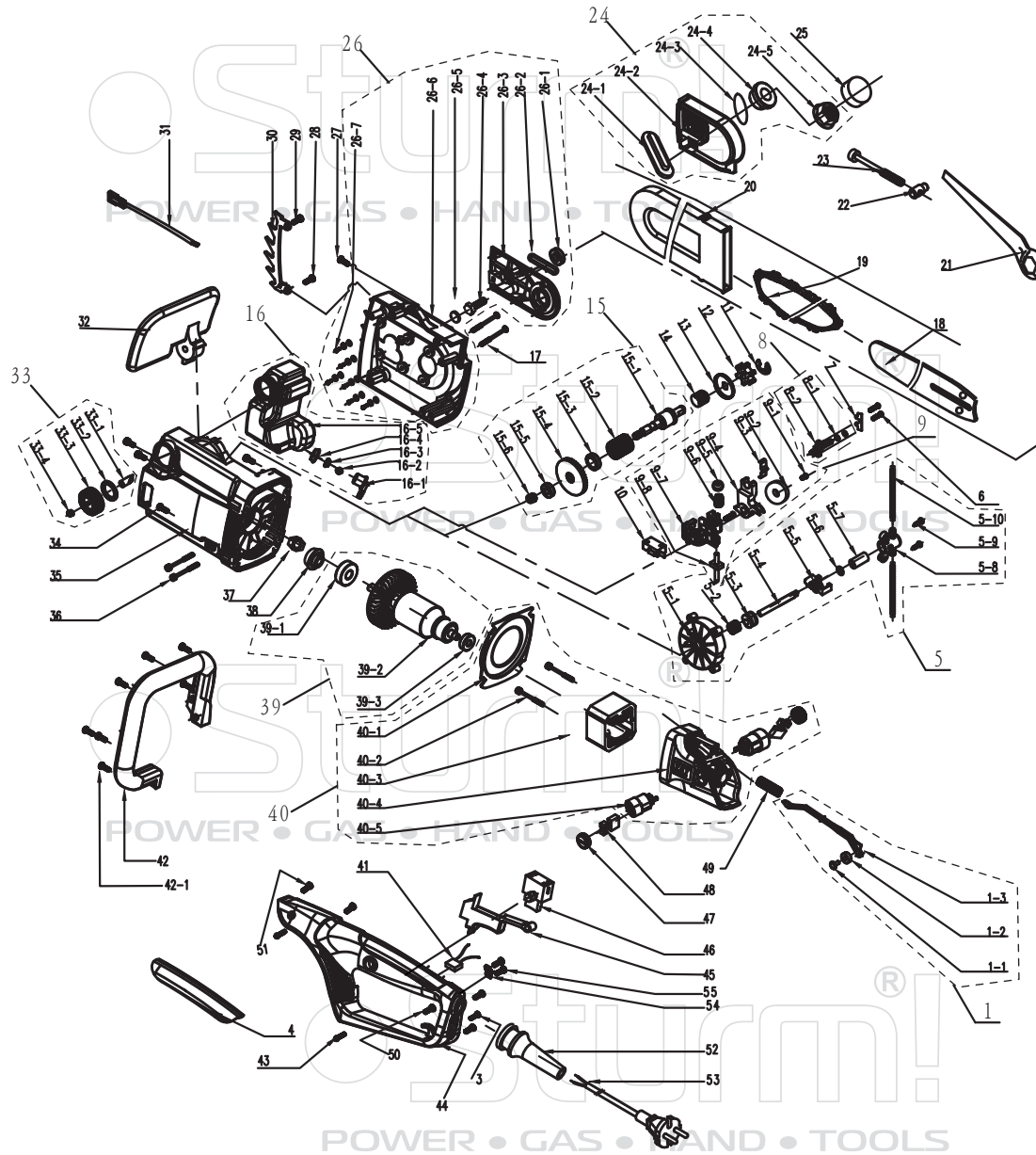

NO.	DESCRIPTION	NO.	DESCRIPTION	NO.	DESCRIPTION
1	SWITCH PUSH ROD GROUP	15-3	SHAFT SLEEVE	33-1	VALVE GROUP
1-1	WHEEL PIN	15-4	UMBRELLA GEAR	33-2	SEALING RING
1-2	SLIDE WHEEL	15-5	REAR BEARING 608Z	33-3	TANK COVER
1-3	SWITCH PUSH ROD	15-6	SELF-LOCKING NUT	33-4	CAP OF TANK COVER
3	SELF-TAPPING SCREW 5*16	16	TANK GROUP	34	SELF-TAPPING SCREW
4	STRIP	16-1	OUTPUT CONNECTOR	35	VARIABLE-SPEED BOX
5	PUMP GROUP	16-2	SPONGE	36	SELF-TAPPING SCREW
5-1	PUMP FIX BOARD	16-3	CHOKE PLUG FOR CONNECTOR	37	NUT
5-2	WORM GEAR	16-4	RUBBER SLEEVE OF CONNECTOR	38	SMALL UMBRELLA GEAR
5-3	WORM WHEEL	16-5	TANK	39	ROTOR GROUPWARE
5-4	PISTON SLEEVE	17	SELF-TAPPING SCREW	39-1	FRONT BEARING 6000Z
5-5	PISTON SUPPORT	18	CHAIN BAR	39-2	ROTOR
5-6	SEALING RING	19	SAW CHAIN	39-3	REAR BEARING 627Z
5-7	PISTON SLEEVE	20	BLADE COVER	40	HOUSING GROUPWARE
5-8	PUMP BODY	21	SPANNER	40-1	WIND SCREEN
5-9	SELF-TAPPING SCREW	22	TENSION NUT	40-2	SELF-TAPPING SCREW
5-10	OIL TUBE	23	TENSION SCREW	40-3	STATOR
6	SELF-TAPPING SCREW	24	END CAP GROUP	40-4	HOUSING
7	BACK PLATE	24-1	END CAP SEAL	40-5	BRUSH HOLDER
8	NOZZLE ASSEMBLY	24-2	END CAP	41	CAPACITOR
8-1	O-RING	24-3	BRAND LABEL	42	ASSISTANCE HANDLE
8-2	OIL CONNECTOR	24-4	SHAFT SLEEVE	42-1	SELF-TAPPING SCREW
9	BRAKING ROD GROUP	24-5	FLANGE NUT	43	SELF-TAPPING SCREW
9-1	MACHINE SCREW	25	NUT SHIELD	44	REAR HANDLE HOUSING ASSEMBLY
9-2	BRAKING WASHER	26	MIDDLE COVER GROUP	45	SWITCH BUTTON
9-3	SPRING LEAF	26-1	BEARING 6900Z	46	SWITCH
9-4	DIVIDER ROD	26-2	SEALING RING FOR OUTPUT CONNECTOR	47	CARBON BRUSH COVER
9-5	WASHER	26-3	MIDDLE COVER INSERT	48	CARBON BRUSH
9-6	BRAKING ROD SPRING	26-4	MACHINE SCREW	49	PUSH ROD SPRING
9-7	BRAKING ROD FIX BOARD	26-5	SEAL SHIM	50	SELF-TAPPING SCREW
9-8	BRAKING ROD	26-6	MIDDLE COVER	51	SELF-TAPPING SCREW
10	CONTROL SWITCH	26-7	MACHINE SCREW	52	CABLE SLEEVE
11	E-CIRCLIP	27	SELF-TAPPING SCREW	53	CABLE
12	SPROCKET	28	SELF-TAPPING SCREW	54	CABLE PRESSURE BOARD
13	SEALING COVER	29	SELF-TAPPING SCREW	55	SELF-TAPPING SCREW
14	SPRING	30	BUFFER BOARD		
15	SHAFT GROUP	31	CONNECTION WIRE		
15-1	SHAFT	32	SWITCH TRIGGER		
15-2	BRAKING SPRING	33	OIL TANK COVER GROUP		

ST20140103