

AW97M14A AW97M16A

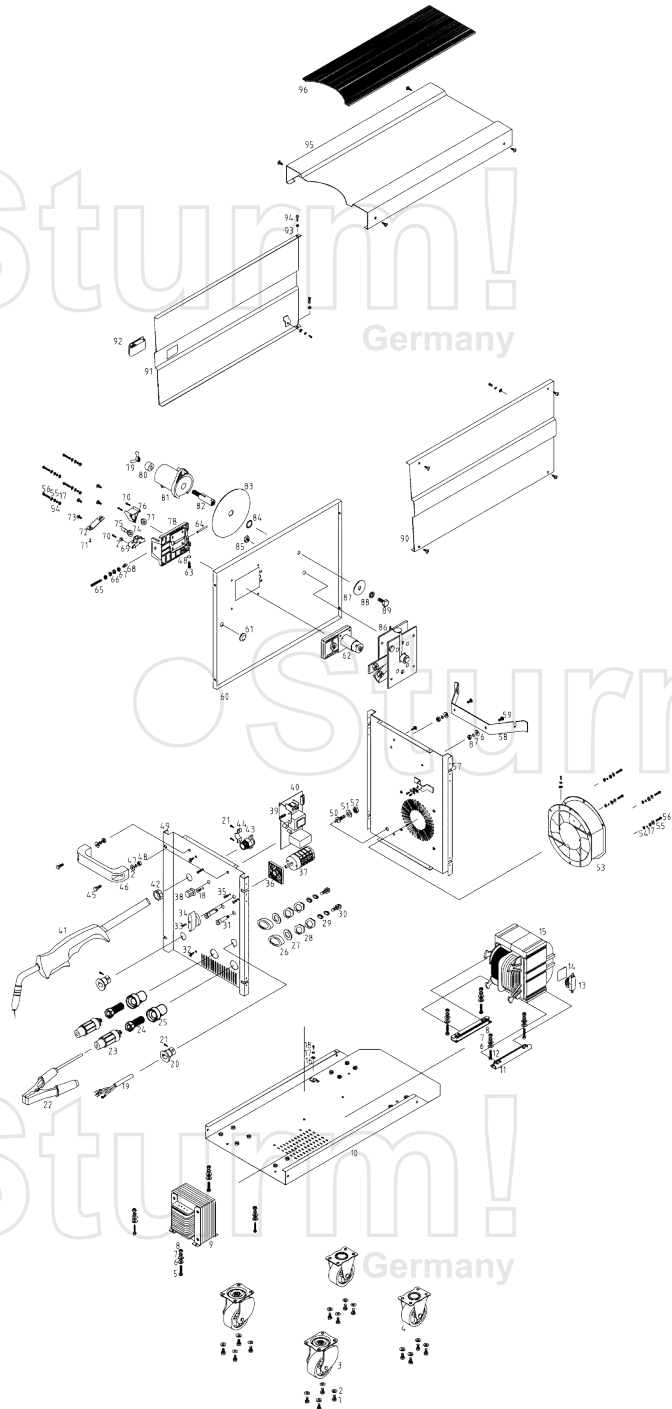

NO.	DESCRIPTION	NO.	DESCRIPTION
1	BOLT	49	FRONT PANEL WITH TEXT
2	FLAT -WASHER	50	GAS GUIDE IN
3	SWIVEL CASTOR	51	FLAT - WASHER
4	CASTOR	52	NUT
5	BOLT	53	ELECTRIC FAN
6	FLAT - WASHER	54	NUT
7	SPRING- WASHER	55	SPRING- WASHER
8	NUT	56	BOLT
9	INDUCTOR	57	BACK PANEL WITH TEXT
10	BOTTOM PLATE	58	CLIP OF GAS CYLINDER
11	U-SHAPED FASTENER	59	BOLT
12	BOLT	60	MIDDLE CLAPBOARD
13	THERMAL CUTOUT	61	RUBBER BAND
14	ALUMINIUM PIECE	62	WIRE FEED UNIT
15	TRANSFORMER	63	SCREW
16	LOCKWASHER	64	WIRE GUIDE IN
17	SPRING-WASHER	65	BOLT
18	BOLT	66	NUT
19	POWER CABLE	67	FLAT - WASHER
20	LOCK SLEEVE OF CABLE	68	WIRE GUIDE OUT
21	TAPPING SCREW	69	PRESSURE ARM COMPL.
22	CLAMP OF WELDED MATERIAL	70	BOLT
23	COUPLING DEVICES	71	CONNECTION PEG
24	CONDUCTOR	72	PRESSURE SET
25	INSULATING JACKET	73	SCREW
26	INSULATING LANTERN RING	74	FEED ROLLER
27	FLAT-WASHER	75	SHAFT
28	NUT	76	SHAFT SUPPORT
29	FLAT-WASHER	77	FEED ROLLER
30	BOLT	78	BRACKET
31	OVERHEAT / POWER INDICATOR	79	BUTTERFLY NUT
32	TAPPING SCREW	80	SHAFT COVER
33	SCREW	81	SHAFT OF WIRE TRAY
34	KNOB	82	SHAFT
35	BOLT	83	BIG WASHER
36	HANDLE OF POWER SWITCH	84	FLAT - WASHER
37	VOLTAGE ADJUSTMENT SWITCH	85	NUT
38	KNOB	86	DIODE BRIDGE
39	SUPPORT OF PCB	87	FLAT - WASHER
40	PCB	88	SPRING- WASHER
41	WELDING GUN AND CABLE,HOSE	89	BOLT
42	LOCKNUT OF CABLE	90	SIDE PANEL (RIGHT)
43	LOCK APPARATUS OF CABLE	91	SIDE PANEL (LEFT)
44	CLIP OF CABLE	92	CLASPER OF GATE
45	BOLT	93	NUT
46	HANDLE	94	BOLT
47	SPRING- WASHER	95	TIP PANEL
48	NUT	96	RUBBER MAT