

CA-97ИН25Б CA-97ИН30Б

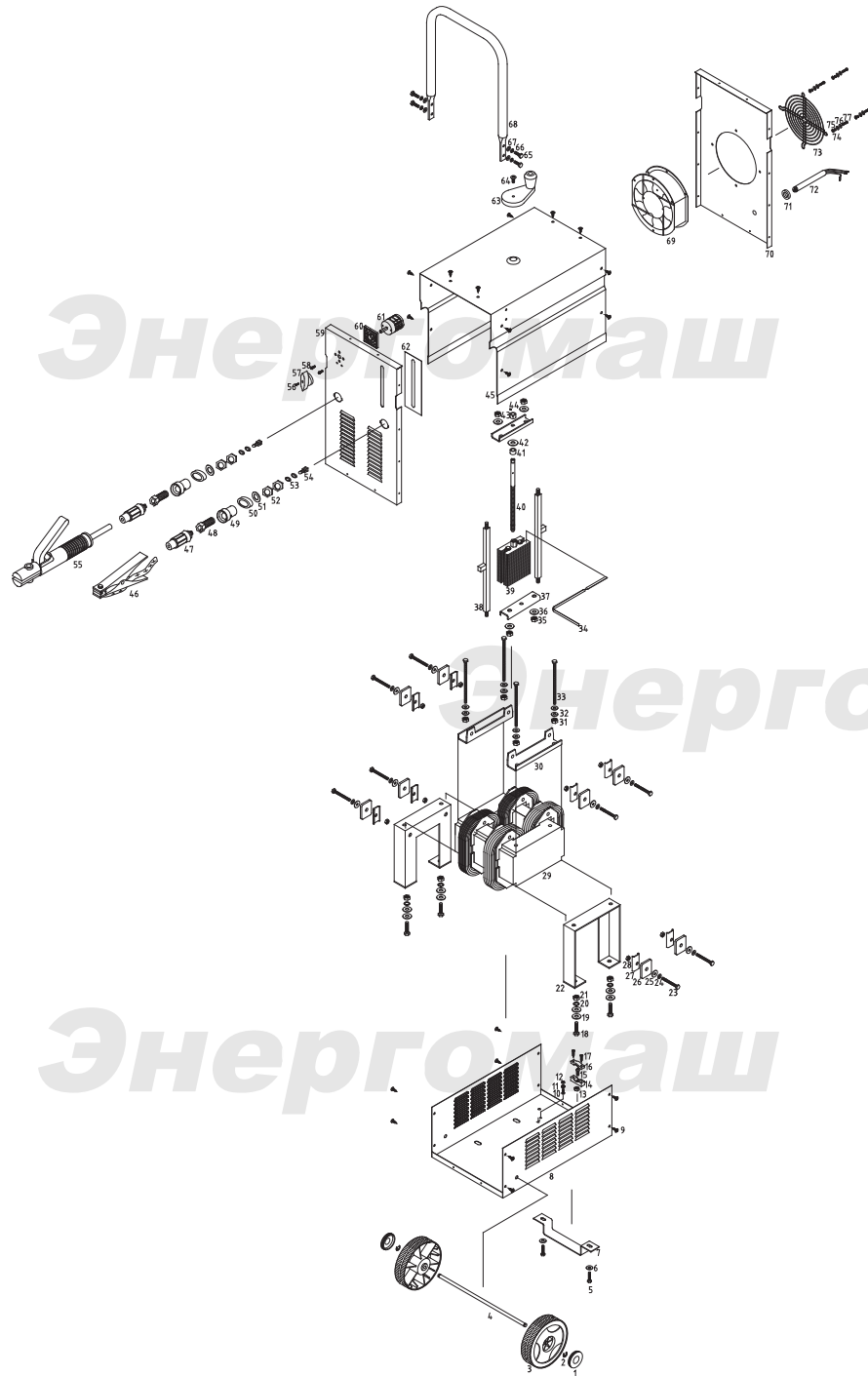

NO.	DESCRIPTION	NO.	DESCRIPTION
1	COVER OF WHEEL	40	THREAD BAR
2	CLIP SPRING	41	SHEATH OF THREAD BAR 1
3	WHEEL	42	FLAT WASHER
4	AXLE	43	SHEATH OF THREAD BAR 2
5	HEX SCREW	44	PIN
6	FLAT WASHER	45	COVER
7	FOOT	46	EARTH CLAMP
8	MOTHERBOARD	47	QUICK CONNECTION
9	TAPPING SCREW	48	COPPER WHORL POLE
10	ROUND BOLT	49	JACK OF CONNECTION
11	LACE WASHER	50	COVER OF CONNECTION
12	NUT	51	FLAT WASHER
13	NUT	52	FLAT NUT
14	PEDESTAL	53	FLAT WASHER
15	ROUND BOLT	54	HEX SCREW
16	PRESSING WIRE BOARD	55	WELDING TORCH
17	TAPPING SCREW	56	BOLT
18	HEX SCREW	57	KNOB OF SWITCH
19	FLAT WASHER	58	ROUND BOLT
20	SPRING WASHER	59	FRONT BOARD
21	NUT	60	JACK OF SWITCH
22	ABOVE RACK	61	SWITCH
23	HEX SCREW	62	CLAIRVOYANT WINDOW
24	FLAT WASHER	63	BOLT WITH
25	INSULATED FLAT WASHER	64	BOLT WITH FLAT WASHER
26	SQUARE INSULATED BOARD	65	HEX SCREW
27	U-SHAPE BOARD	66	FLAT WASHER
28	NUT	67	SPRING WASHER
29	TRANSFORMER	68	HANDLE
30	NETHER RACK	69	FAN
31	M6 NUT	70	BACK BOARD
32	FLAT WASHER	71	RUBBER BAND
33	HEX SCREW	72	POWER CABLE
34	NEEDLE	73	COVER OF FAN
35	NUT	74	NUT
36	FLAT WASHER	75	FLAT WASHER
37	U-SHAPE RACK OF MOVING IRON	76	SPRING WASHER
38	STRIP RACK OF MOVING IRON	77	ROUND BOLT
39	MOVING IRON		