

JS4120CL

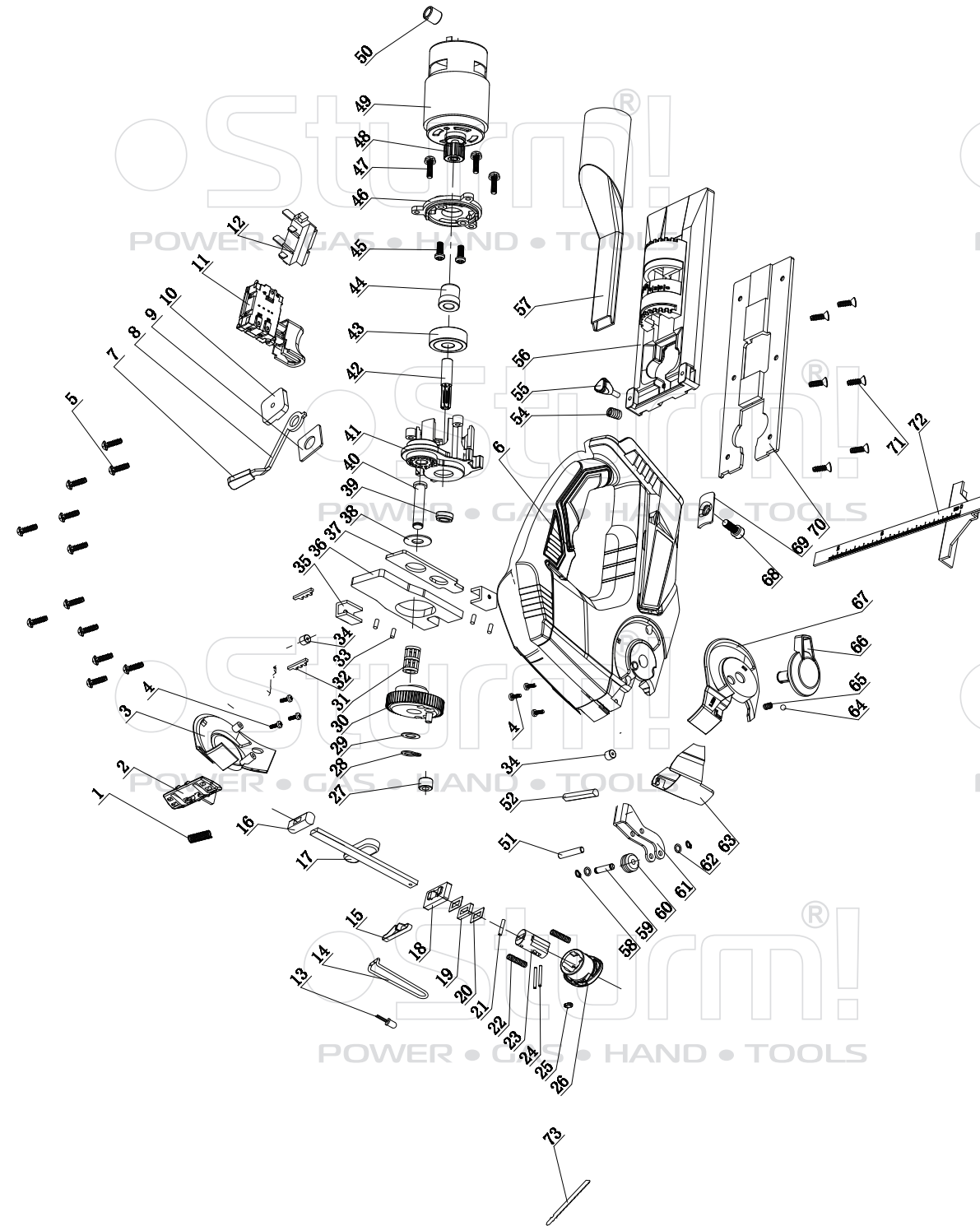

NO.	DESCRIPTION	NO.	DESCRIPTION
1	SAFETY BUTTON SPRING	38	WASHER
2	SAFETY BUTTON	39	SHAFT SLEEVE
3	RIGHT DECORATIVE COVER	40	PIN SHAFT
4	M3X8 CROSS RECESSED PAN HEAD M SCREW	41	GEAR BOX HOUSING
5	ST4X14 CROSS RECESSED PAN HEAD ST SCREW	42	SMALL SPUR GEAR
6	HOUSING	43	BEARING 608-2Z
7	BUTTON OF QUICK - ADJUSTING TRIGGER	44	INTERNAL SPLINE GEAR
8	QUICK - ADJUSTING TRIGGER	45	M4X12 CROSS RECESSED PAN HEAD M SCREW W/SPRING WASHER
9	QUICK - ADJUSTING LOWER PRESSPLATE	46	MOTOR MOUNTING
10	QUICK - ADJUSTING UPPER PRESSPLATE	47	M4X10 CROSS RECESSED HEAD M SCREW
11	SWITCH	48	EXTERNAL SPLINE GEAR
12	CONNECT PLATE HOLDER FOR MAIN UNIT	49	MOTOR
13	LED ASSY	50	MAGNETIC RING
14	SAFETY SPRING WIRE	51	CUTTER LIFTING PIN
15	LEAF SPRING	52	ORBITAL ADJUSTMENT PIN
16	UPPER SLIDING BUSH	54	SPRING FOR KNOB
17	SLIDING ROD ASSY	55	KNOB FOR GUIDE RULE
18	LOWER SLIDING BUSH	56	BASE PLATE
19	RUBBER GREASE SEAL	57	DUST COLLECTION TUBE
20	WASHER FOR GREASE SEAL	58	STOP RING E-3
21	ROUND PIN	59	GUIDE WHEEL SHAFT 4*18.5
22	CLAMPING SPRING FOR SAW BLADE	60	GUARD WHEEL
23	BLADE CLAMPING BODY	61	CUTTER LIFTING HOLDER
24	CLAMPING PIN FOR SAW BLADE	62	FLAT WASHER 4
25	SEAL PLUG FOR SLIDING BUSH OF BLADE CLAMPING HEAD	63	FRONT TRANSPARENT COVER
26	SLIDING BUSH OF BLADE CLAMPING HEAD	64	STEEL BALL Ø5
27	BUSH	65	ORBITAL ADJUSTMENT SPRING
28	RETAINING RING FOR SHAFTS 8	66	ORBITAL ADJUSTMENT KNOT
29	WASHER OF BIG GEAR	67	TD8212 LEFT DECORATIVE COVER
30	BIG SPUR GEAR	68	M5X16 HEXAGONAL SOCKET HEAD CAP SCREW
31	DOUBLE ROW NEEDLE ROLLER BEARING	69	PRESSPLATE
32	FORK OF ANGLE ADJUSTMENT	70	BASE PAD
33	STEEL PIN	71	M4X8 CROSS RECESSED COUNTERSUNK HEAD M SCREW
34	SHAFT SLEEVE	72	GUIDE RULE
35	GUIDED SLIDING BLOCK	73	WOOD CUTTING BLADE
36	BALANCE PLATE		
37	PUSH PLATE		

UK-ST20191206

