

BKC-93155

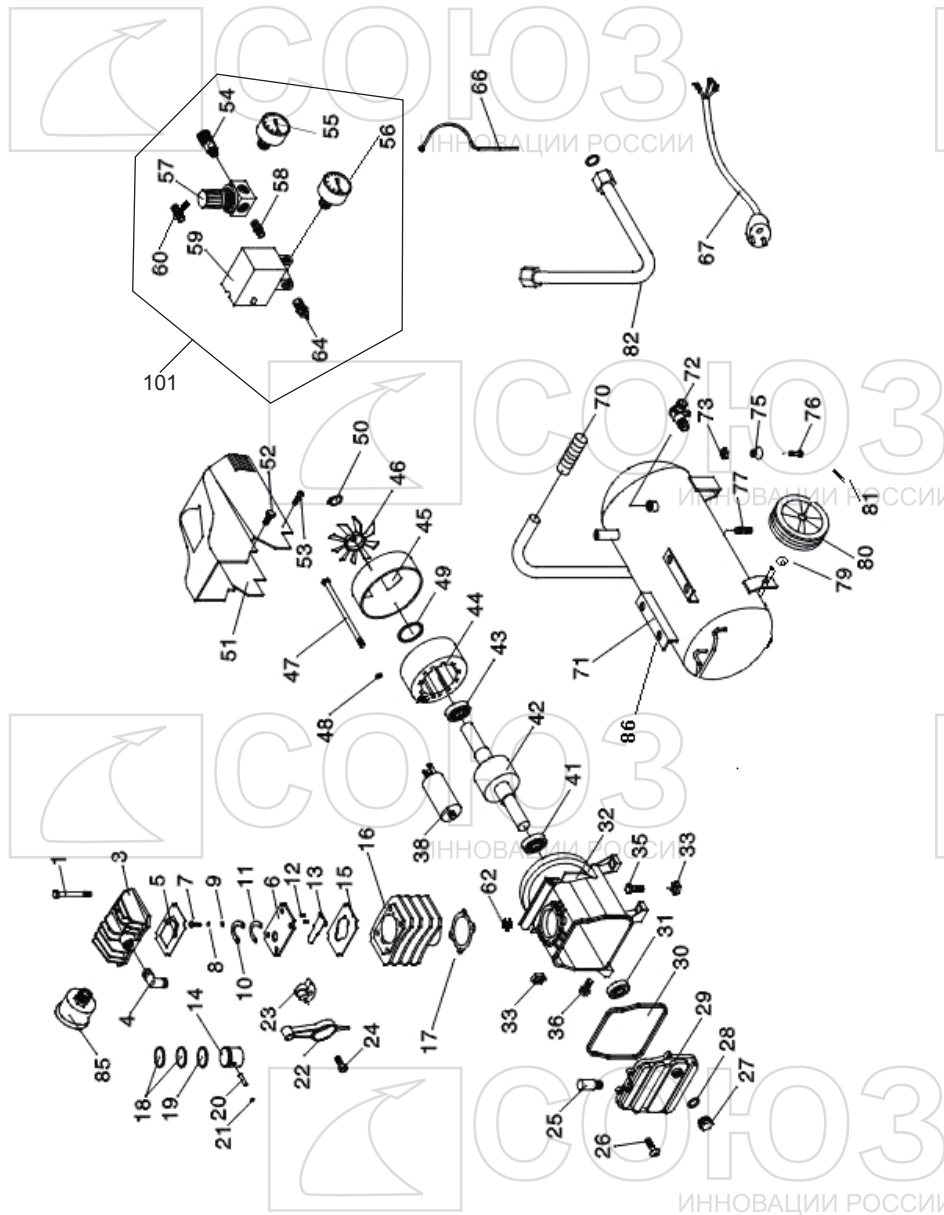

NO.	DESCRIPTION	NO.	DESCRIPTION
1	HEX BOLT WITH WASHER	43	BEARING 6202
3	CYLINDER HEAD	44	STATOR WITH THERMAL PROTECTOR
4	EXHAUST ELBOW	45	REAR MOTOR COVER
5	CYLINDER GASKET	46	FAN
6	VALVE PLATE	47	HEX BOLT
7	SCREW	48	LOCK WASHER
8	LOCKWASHER	49	SPACER
9	FLAT WASHER	50	EXT RETAINING RING
10	VALVE LIMITER	51	FAN COVER
11	VALVE REED	52	HEX BOLT
12	POSITION PIN	53	SCREW
13	INLET VALVE	54	QUICK COUPLER
14	PISTON	55	PRESSURE GAUGE (SMALL)
15	CYLINDER GASKET UPPER	56	PRESSURE GAUGE (BIG)
16	CYLINDER	57	REGULATOR
17	CYLINDER GASKET LOWER	58	CONNECTOR
18	COMPRESSION RING	59	PRESSURE SWITCH
19	OIL RING	60	BALL VALVE COUPLER
20	PISTON PIN	62	OVERLOAD PROTECTOR
21	EXT RETAINING RING	64	SAFETY VALVE
22	CONNECTING ROD	66	RELIEF TUBE ASSEMBLY
23	ECCENTRICITY	67	POWER CORD & PLUG
24	SCREW	70	HANDLE GRIP
25	BREATH PIPE	71	TANK
26	SCREW	72	CHECK VALVE
27	OIL INDICATOR SIGHT	73	HEX NUT
28	OIL INDICATOR SEAL	75	FOOT
29	CRANKCASE COVER	76	HEX BOLT
30	COVER SEAL	77	DRAIN VALVE
31	OIL SEAL	79	LOCK WASHER
32	CRANKCASE	80	WHEEL
33	HEX NUT	81	PIN
35	HEX BOLT	82	DISCHARGE PIPE ASSEMBLY
36	OIL PLUG	85	AIR FILTER
38	CAPACITOR	86	RUBBER PAD
41	BEARING 6204	101	PRESSURE SWITCH AND AIR CONNECTOR ASSEMBLY
42	ROTOR		

SO20121122