

ЦП-50185П

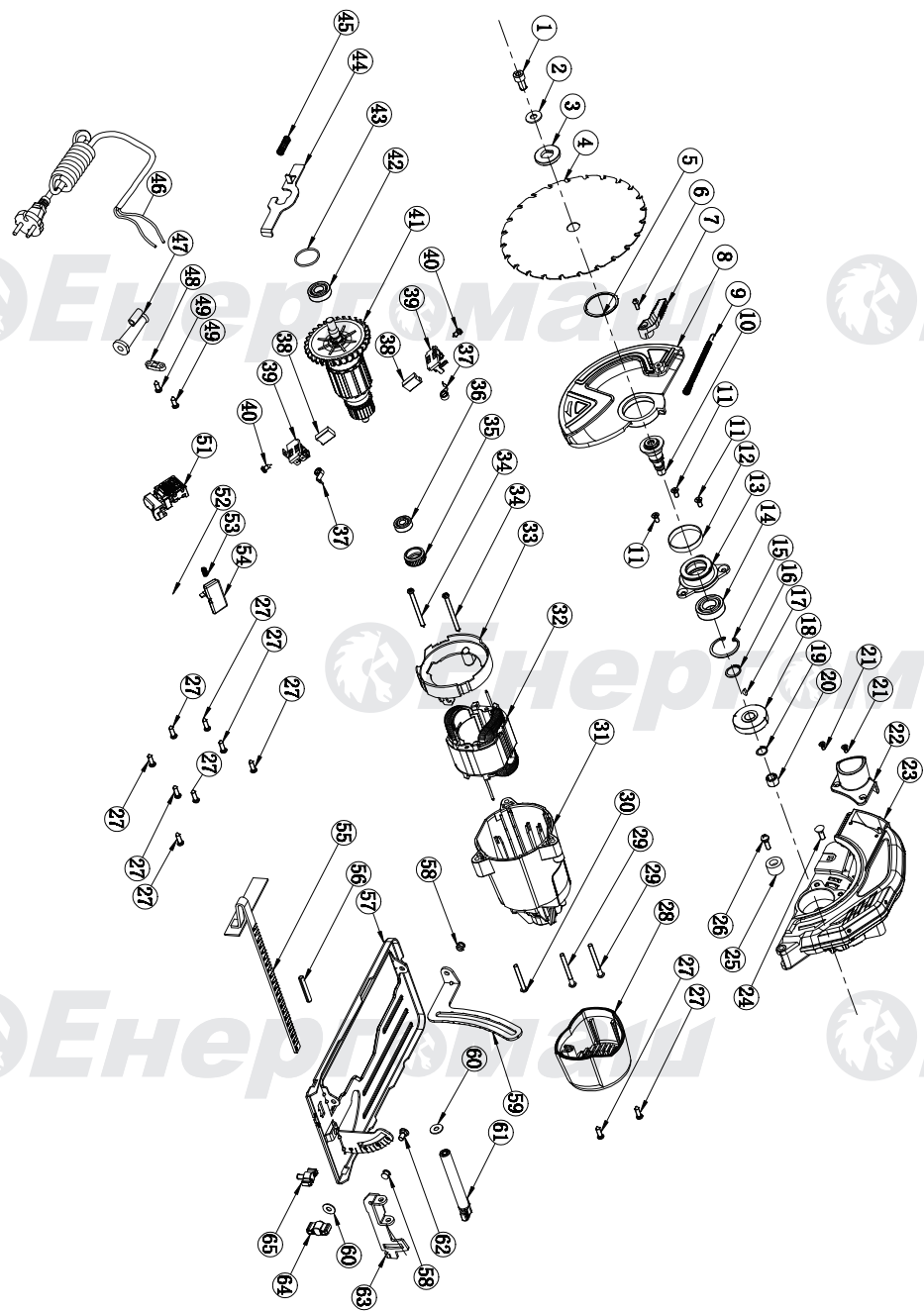

NO.	DESCRIPTION	NO.	DESCRIPTION
1	Screw M8X16	34	cross Screw M4.2×60
2	Flange	35	608 Bearing sleeve (skeleton)
3	Outer Flange	36	Ball bearings 608-2Z
4	Saw blade φ185	37	Coil spring
5	Steel circlip	38	Carbon Brush7.5X14X20
6	Cross Screw M4×12	39	Carbon brush holder
7	lower cover button	40	cross Screw M4.2×10
8	lower cover	41	rotor
9	spring	42	Ball bearings 6001-2RS
10	outershaft	43	O ring(Φ1.8XΦ28)
11	cross Screw M5×10	44	Shaft lock
12	Friction reducing ring	45	lock spring
13	front cover	46	Cable
14	ball bearing6003-2RS	47	Cable cover
15	circlip φ35	48	Cable plate
16	circlip φ17	49	cross Screw M4.2×13
17	woodruff key 3X3.7X10	51	switch
18	big gear	52	I handle
19	circlip φ12	53	Button spring
20	Needle bearingHK1010	54	Switch button
21	Cross Screw M4×8	55	Guide ruler
22	Vacuum adapter	56	spring pin D6X40
23	Gear box	57	Basing plate
24	square neck bolt M6X16	58	Rivet D6X8
25	Rubber column	59	Depth Adjust Frame
26	cross Screw M5×18	60	Flat washer (Φ6XΦ16)
27	cross Screw M4.2×16	61	Depth Button
28	rear cover	62	Bolt M6X12
29	cross Screw M5×50	63	Angle Adjust frame
30	cross Screw M5×40	64	Angle button
31	motor cover	65	Guide lock knob
32	stator		
33	Fan shroud		

UK-EN20190522