

ЭГ-87122

NO.	DESCRIPTION	NO.	DESCRIPTION
1	FUEL TANK COVER	37	HEX. FLANGE BOLT
2	FUEL TANK SEAL	38	FLAT WAHSER
3	FILTER SCREEN	39	HEX. FLANGE BOLT
4	FUEL GAUGE (INDICATOR)	40	BACK COVER
5	HEX. FLANGE BOLT	41	HEX. FLANGE BOLT
6	FLAT WASHER	42	HEX. FLANGE BOLT
7	BUSH	43	COLLAPSIBLE BEAM
8	FUEL TANK CUSHION	44	PANEL
9	FUEL TANK	45	SWITCH
10	FUEL TANK SWITCH FILTER SCREEN	46	NUT
11	FUEL TANK SWITCH SEAL	47	SPRING WASHER
12	NUT	48	FLAT WAHSER
13	FUEL TANK SWITCH ASSEMBLY	49	VOLTMETER
14	FUEL PIPE CLAMP	50	BREAKER
15	FUEL PIPE	51	CROSS HEAD BOLT
16	FLAME	52	CROSS HEAD BOLT
17	ENGINE	53	FLAT WAHSER
18	AIR FILTER BRACKET	54	EURO STYLE SOCKET
19	HEX. FLANGE BOLT	55	NUT
20	MUFFLER SEAL	56	SPRING WASHER
21	MUFFLER ASSEMBLY	57	FLAT WAHSER
22	SPRING WASHER	58	HEX. FLANGE BOLT
23	HEX. FLANGE BOLT	59	TERMINAL
24	HEX. FLANGE BOLT	60	INDICATOR LIGHT
25	MUFFLER GUARD	61	FUSE
26	HEX. FLANGE BOLT	62	PANEL REAR COVER
27	MUFFLER SUPPORT BRACKET	63	CORD SHEATH
28	ROTOR	64	NUT
29	STATOR WINDING	65	SMALL CUSHION PAD
30	MOTOR REAR COVER	66	FLAT WAHSER
31	RECTIFIER	67	SPRING WASHER
32	HEX. FLANGE BOLT	68	BIG CUSHION PAD
33	CARBON BRUSH ASSEMBLY	69	FLAME STAND
34	CONNECTION BLOCK	70	FLAT WAHSER
35	HEX. FLANGE BOLT	71	NUT
36	AVR		

EN20130701

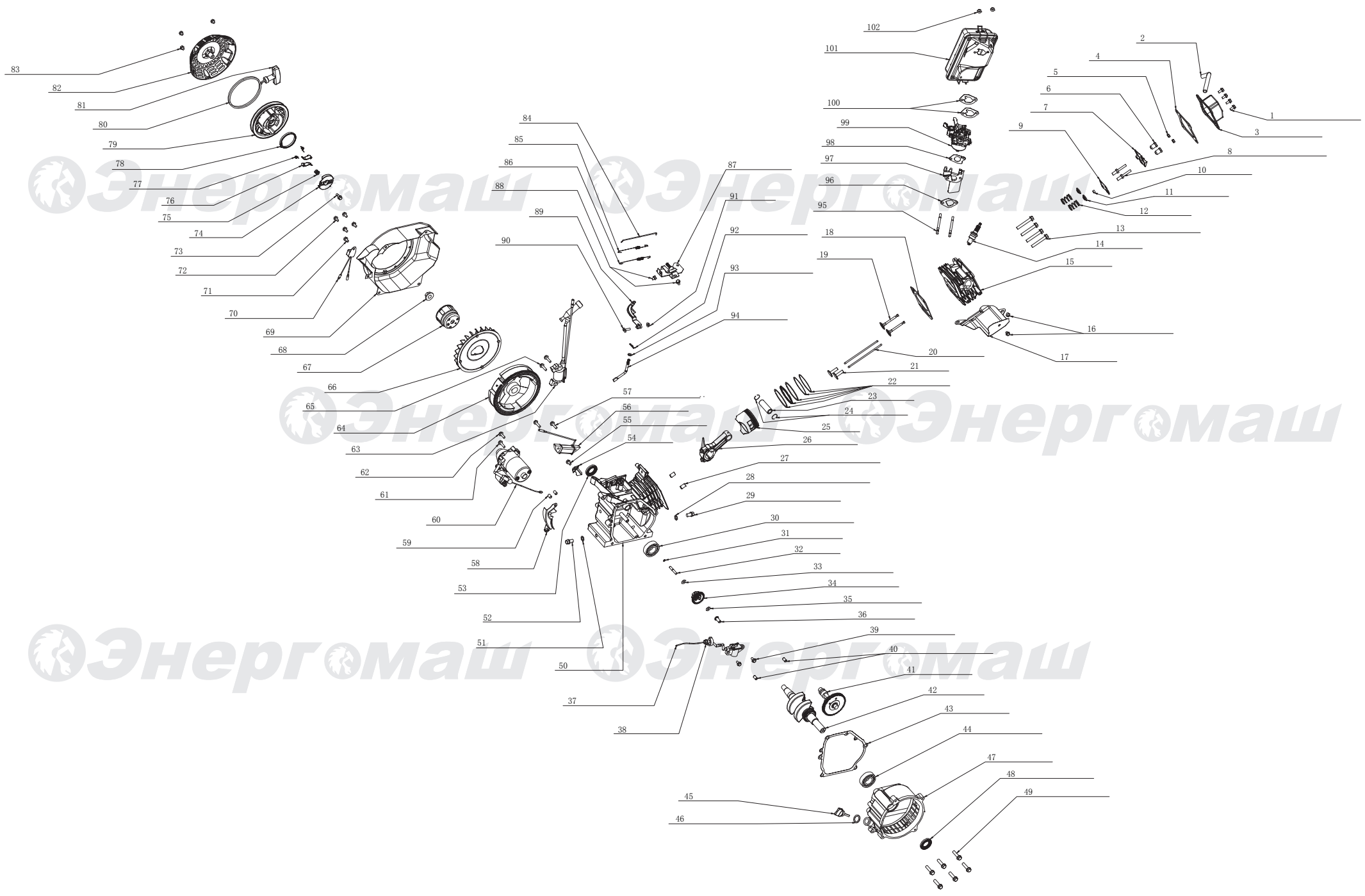

ЭЛЕКТРОДВИГАТЕЛЬ ДЛЯ ЭГ-87122

NO.	DESCRIPTION	NO.	DESCRIPTION
1	HEX. FLANGE BOLT	52	OIL DRAIN BOLT
2	RIGHT-ANGLE WASTE PIPE	53	OIL SEAL
3	CYLINDER HEAD COMP	54	PRESSURE BOARD
4	CYLINDER HEAD SEAL	55	HEX. FLANGE BOLT
5	VALVE CLEARANCE ADJUSTING NUT	56	CHARGE COIL ASSY
6	VALVE ARM NUT	57	HEX. FLANGE BOLT
7	VALVE ARM	58	FLY WHEEL GUARD
8	BOLT	59	MOTOR ASSY POSITION PIN
9	LEVER BRACKET	60	MOTOR ASSY
10	VALVE HEAD CAP	61	HEX. FLANGE BOLT
11	VALVE SPRING BASE	62	HEX. FLANGE BOLT
12	VALVE SPRING	63	IGNITION COIL ASSY
13	BOLT	64	FLY WHEEL WITH GEAR
14	SPARK PLUG	65	HEX. FLANGE BOLT
15	CYLINDER HEAD	66	FAN
16	HEX. FLANGE BOLT	67	START COVER
17	DOWN WINDING GUARD	68	NUT
18	CYLINDER HEAD SEAL GASKET	69	FAN COVER
19	INTAKE AND EXHAUST VALVE	70	ONE-WAY CONDUCTOR ASSY
20	LEVER ASSEMBLY	71	HEX. FLANGE BOLT
21	LITER	72	HEX. FLANGE BOLT
22	PISTON RING ASSY	73	PRESSURE BOARD SCREW
23	PISTON PIN	74	PRESSURE BOARD
24	PISTON PIN CIRCLIP	75	PRESSURE BOARD SPRING
25	PISTON	76	RATCHET
26	CONNECTION ROD ASSY	77	RATCHET SPRING
27	VALVE HEAD POSITION PIN	78	SPRING
28	OIL DRAIN BOLT WASHER	79	RECOIL STARTER REEL
29	OIL DRAIN BOLT	80	PULLING CORD
30	DEEP GROOVE BALLING BEARING 6205	81	HANDLE
31	CIRCLIP FOR SPEED ADJUSTING SHAFT	82	REEL COVER
32	SPEED ADJUSTING SHAFT	83	HEX. FLANGE BOLT
33	WASHER	84	GOVERNOR ROD
34	SPEED GEAR ASSY	85	TRIMMING SPEED SPRING
35	WASHER	86	RESET SPRING
36	SPEED ADJUSTING SHAFT BUSH	87	GOVERNOR BASE ASSY
37	OIL SENSOR ASSY	88	HEX. FLANGE BOLT
38	NUT	89	GOVERNOR ARM
39	HEX. FLANGE BOLT	90	T-SHAPED BOLT
40	CRANKCASE POSITION PIN	91	NUT
41	CAMSHAFT ASSY	92	GOVERNOR ROD PIN CLAMP
42	CRANK ASSY	93	WASHER
43	CRANKCASE PAPER WASHER	94	GOVERNOR ROD CLAMP
44	DEEP GROOVE BALLING BEARING 6205	95	STUD BOLT
45	OIL LEVEL CAP ASSEMBLY	96	INTAKE WASHER
46	OIL LEVEL SEAL	97	CARBURETOR HEAT INSULATOR
47	CRANKCASE HIGH COVER	98	(OUT)CARBURETOR WASHER
48	OIL SEAL	99	CARBURETOR ASSEMBLY
49	HEX. FLANGE BOLT	100	(IN)CARBURETOR WASHER
50	CRANKCASE	101	AIR FILTER ASSEMBLY
51	OIL DRAIN BOLT WASHER	102	NUT

EN20130701