

PCC-14305

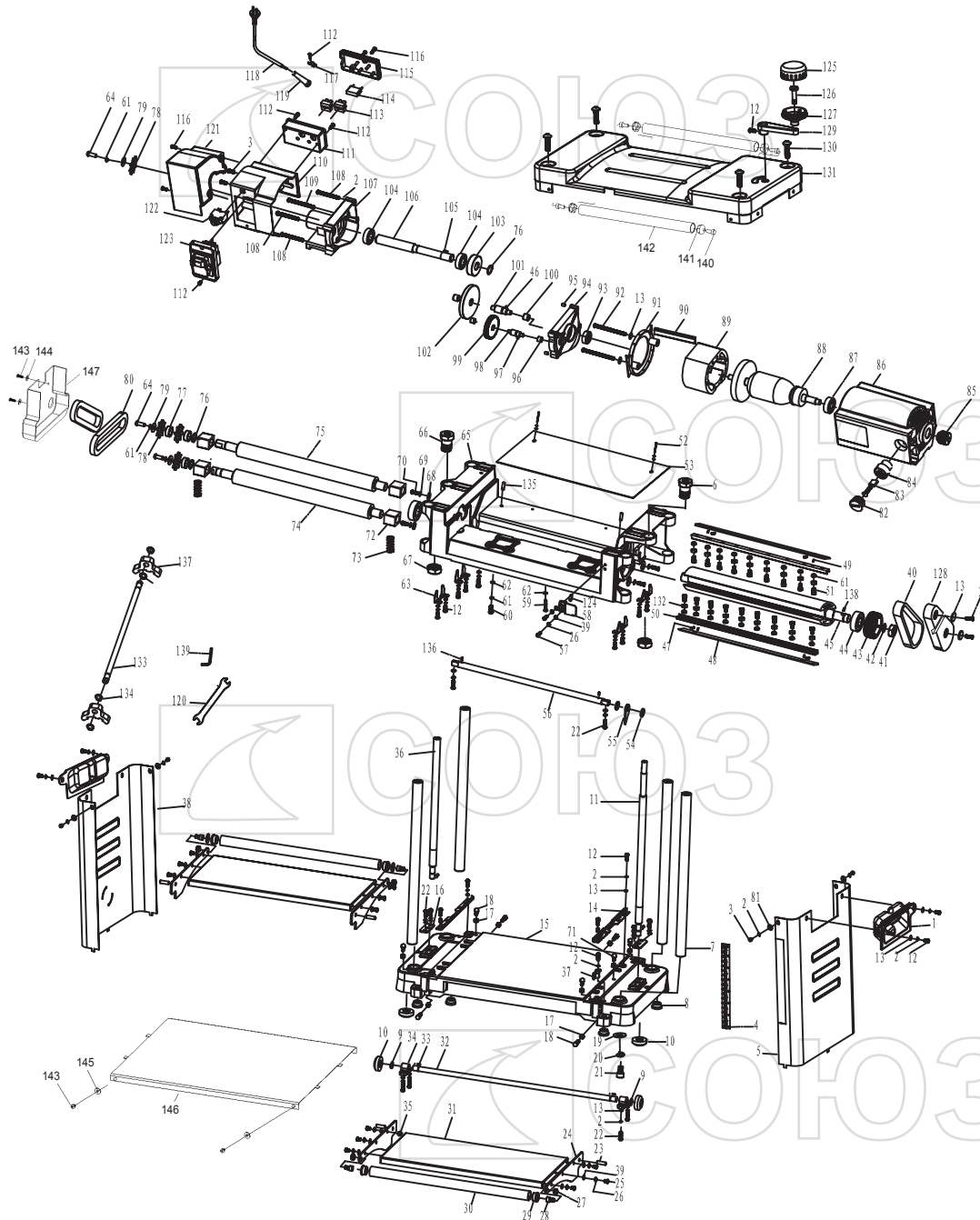

NO.	DESCRIPTION	NO.	DESCRIPTION	NO.	DESCRIPTION
1	HANDLE	50	PRESS PLANK	99	BEVEL GEAR 1
2	SPRING WASHER	51	OUTER HEXAGON SCREW	100	BUSH
3	SCREW	52	INNER HEXAGON SCREW	101	GEAR SHAFT 2
4	STAFF GAUGE	53	BAFFLE	102	GEAR 1
5	RIGHT BOARD COVER	54	WASHER	103	GEAR 2
6	SCREW (RIGHT)	55	RECOIL CLAW	104	BEARING 6002
7	GUIDE ROD	56	BOUNCE-BACK AXIS	105	WOODRUFF KEY
8	RUBBER FEET	57	SCREW	106	OUTPUT SHAFT
9	ELASTIC CIRCLIP	58	POINTER	107	GEAR BOX
10	BEVEL GEAR	59	SCREW	108	SCREW
11	RIGHT LEAD SCREW	60	SCREW	109	SCREW
12	SCREW	61	SPRING WASHER	110	BACK COVER
13	FLAT WASHER	62	FLAT WASHER	111	CONNECTION SEAT
14	ORIENTATION PLANK	63	BEARING PRESS PLATE	112	SCREW
15	BASE PLATE	64	SCREW	113	CONNECTOR
16	SCREW CLAMP	65	ENGINE BODY	114	CAPACITANCE
17	HEX NUT	66	NUT	115	JUNCTION BOX
18	HEXAGON BOLT	67	HEX NUT	116	SCREW
19	FLAT WASHER	68	FLAT WASHER	117	TENSION DISC
20	SPRING WASHER	69	WASHER	118	CABLE
21	SCREW	70	SCREW	119	CABLE SHEATH
22	SCREW	71	HEXAGON BOLTS	120	OPEN SPANNER
23	ELASTIC CYLINDRICAL PIN	72	SQUARE BEARING	121	BACK COVER END PLATE
24	SUPPORT FEET	73	PRESSURE SPRING 1	122	OVERCURRENT PROTECTIVE DEVICE
25	SCREW	74	IRON ROLLER	123	SWITCH
26	SPRING WASHER	75	RUBBER ROLLER	124	POINTER WASHER
27	LOCKNUT	76	ELASTIC COLLAR	125	HANDLE COVER
28	SCREW	77	ADJUSTING SLEEVE	126	HANDLE SCREWS
29	PLUG	78	CHAIN WHEEL 1	127	HAND SHANK
30	ROLL POLE	79	BIG FLAT WASHER	128	BELT COVER
31	EXTENSION PLATE	80	CHAIN	129	ROCKER
32	RAIL	81	THICK FLAT MAT	130	SCREW
33	WOODRUFF KEY	82	CARBON BRUSH HOLDER COVER	131	UPPER COVER PLATE COMPONENTS
34	RAIL BEARING	83	CARBON BRUSH	132	SQUARE NUT
35	HEX NUT	84	CARBON BRUSH HOLDER	133	KNIFE GAUGE SHAFT
36	LEFT LEAD SCREW	85	SMALL PULLEY	134	ELASTIC COLLAR
37	PRESSER PLATE	86	MAIN CASE	135	INNER HEXAGON SCREW
38	LEFT BOARD COVER	87	BEARING 6201	136	ELASTIC CYLINDRICAL PIN
39	FLAT WASHER	88	ARMATURE	137	KNIFE GAUGE
40	PJ RIBBED BELT	89	STATOR	138	CYLINDRICAL PIN
41	THIN NUT	90	WIRE JACKET	139	4MM ALLEN KEY
42	WAVE WASHER	91	BREAK WIND RING	140	PIN
43	BIG RUNNING WHEEL	92	SCREW	141	PLUG1
44	BEARING 6203	93	BEARING 6200	142	ROLL POLE1
45	KNIFE SHAFT	94	MIDDLE COVER	143	CROSS RECESS PAN HEAD SCREW
46	STEEL BALL	95	LOCATION SLEEVE	144	FLAT WASHER
47	PRESSURE SPRING 4	96	BUSH	145	WASHER
48	KNIFE BLADE	97	STEEL BALL	146	PANEL
49	ELASTIC CYLINDRICAL PIN	98	GEAR SHAFT1	147	DUST DEFENDER