

AG9112P

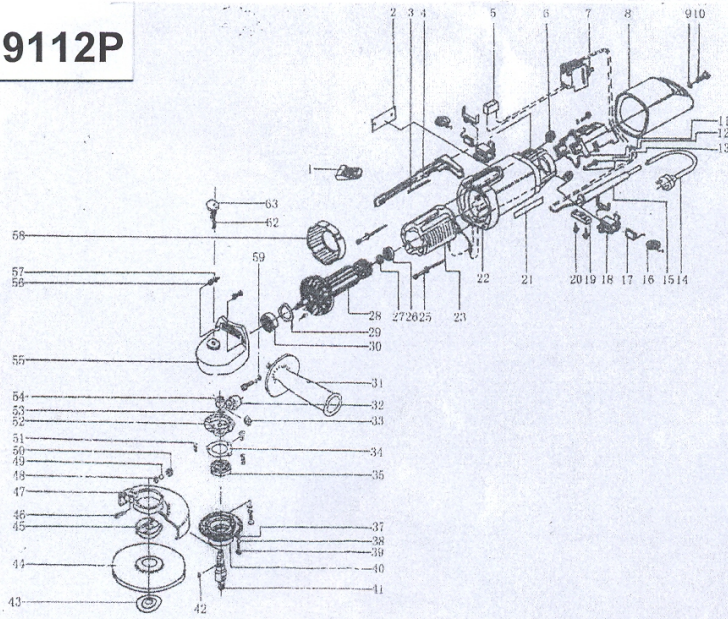

no.	describe	no.	describe
1	Switch knob	32	Bevel gear
2	Name plate	33	Hex nut
3	Spring	34	Bearing cover
4	Slide bar	35	Bearing
5	Electric capacity	37	Plate washer
6	Inductance	38	Spring washer
7	Switch	39	screw
8	Back cover	40	End cover
9	Spring washer	41	Spindle
10	Screw	42	Semi-circular key
11	Switch holder	43	Clamp nut
12	Tapping screwST4.2X16	44	Abrasive disc
14	Cord	45	Flange
15	Cord armor	46	Screw
16	Cup spring	47	Protection cover
17	Carbon brush	48	Plate washer
18	Brush holder	49	Spring washer
19	Cable clip	50	Hex nut
20	Screw	51	Screw
21	Brand lable	52	Big gear
22	Frame	53	Retaining ring
23	Stator	54	Needle bearing
25	Tapping screw	55	Drive-gear box
26	Bearing bushing	56	Tapping screw
27	Ball bearing	57	washer
28	Armature	58	Dust cover
29	Baffle for aperture	62	Spring
30	Ball bearing	63	Button
31	Handle		