

999

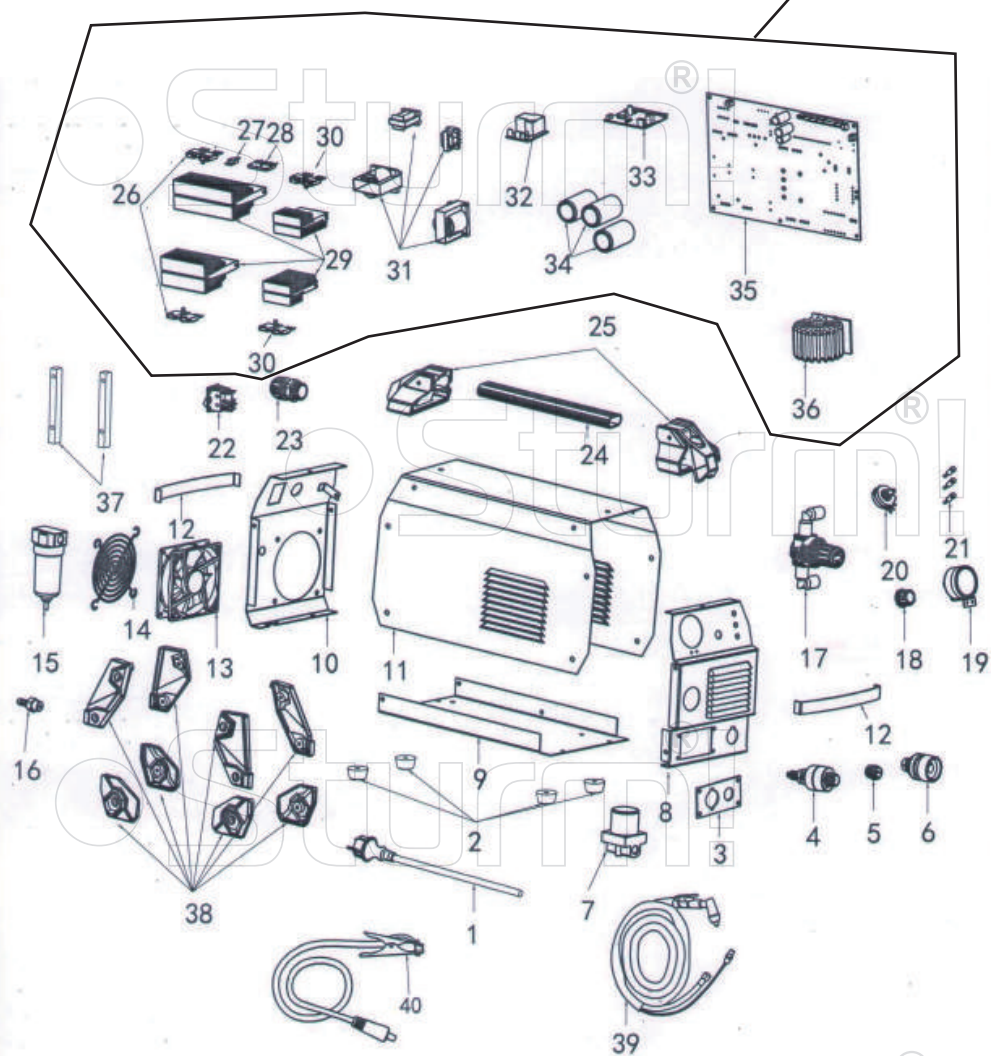

## AW97PC45

NO.	DESCRIPTION	NO.	DESCRIPTION
1	Power cable	29	Heat sink (26)
2	Plastic foot pad	30	Fast recovery diode
3	Insulating plate	31	Transformer
4	Gas-electric joint	32	Reply
5	Aviation plug	33	Signal board
6	Fast connector	34	Capacitor
7	Magnetic valve	35	Main circuit board assembled
8	Front of panel	36	Main transformer
9	Button case	37	Plastic support
10	Back of panel	38	Plastic cover
11	Beside of case	39	PT-31 torch
12	Brand of plate	40	Cable with clamp
13	Fan 24V 5000RPM	999	main board assembly
14	Fan cover		
15	Oil and water diverter		
16	Admission piece		
17	Pressure regulating valve		
18	Knob		
19	Gas-pressure meter		
20	Potentiometer		
21	LED indicator		
22	Power switch		
23	The power cord buckle		
24	Metal of handle		
25	The handle seat		
26	IGBT		
27	NTC		
28	Rectifier bridge		

# AW97PC45 FRONT-BOARD

QC

PMB-26 2017. 08. 08

