

BC12110V

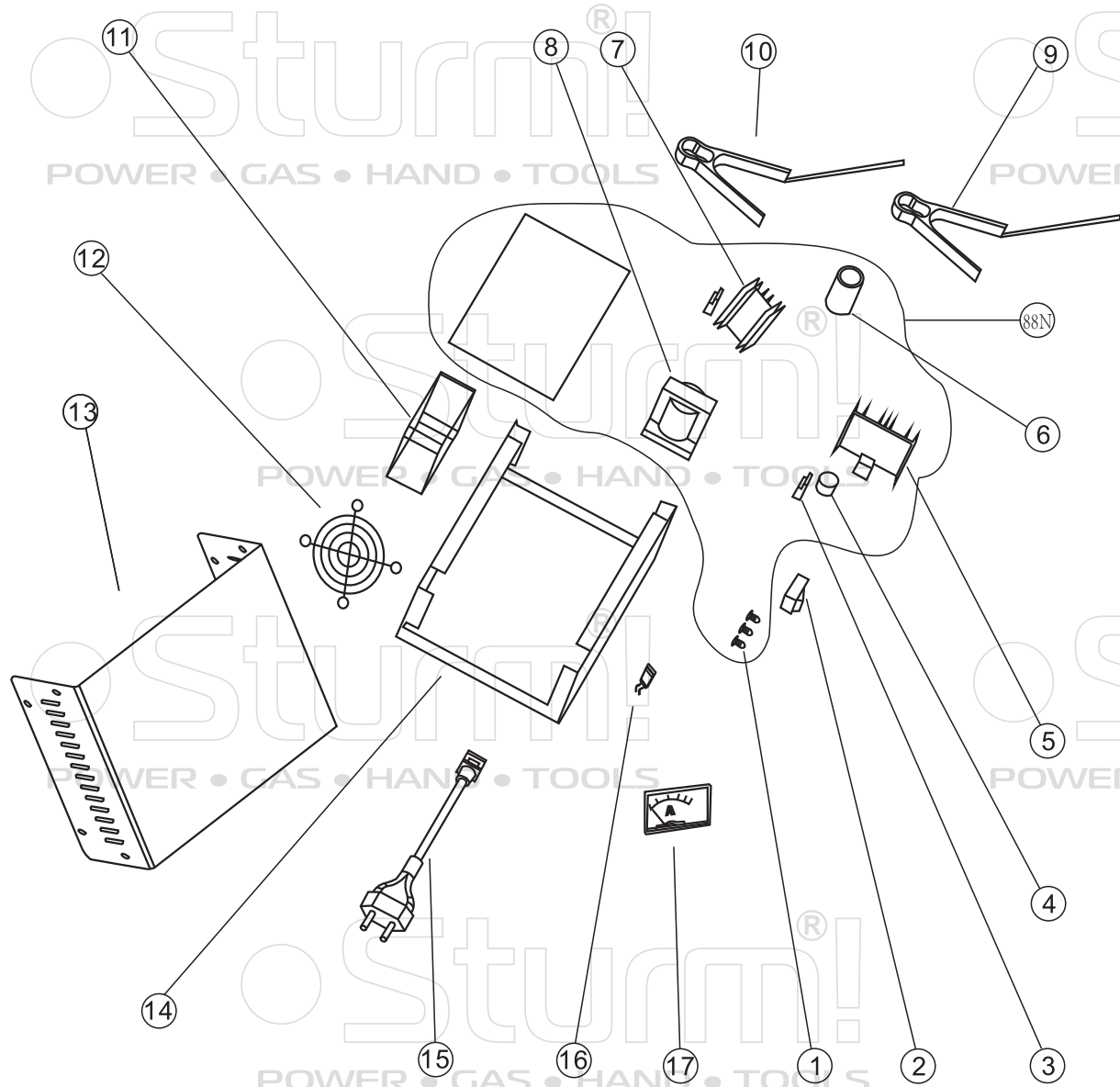

NO.	DESCRIPTION
1	LED
2	SWITCH
3	MOSFET
4	BUZZER
5	POWER IC
6	CAPACITY
7	DIODE
8	TRANSFORMER
9	RED CLAMP
10	BLACK CLAMP
11	FAN
12	FAN COVER
13	COVER SHEER
14	BOTTOM SHEET
15	POWER CABLE
16	HEAT PROTECTOR
17	METER
88N	BOARD ASSEMBLY