

# EH72101

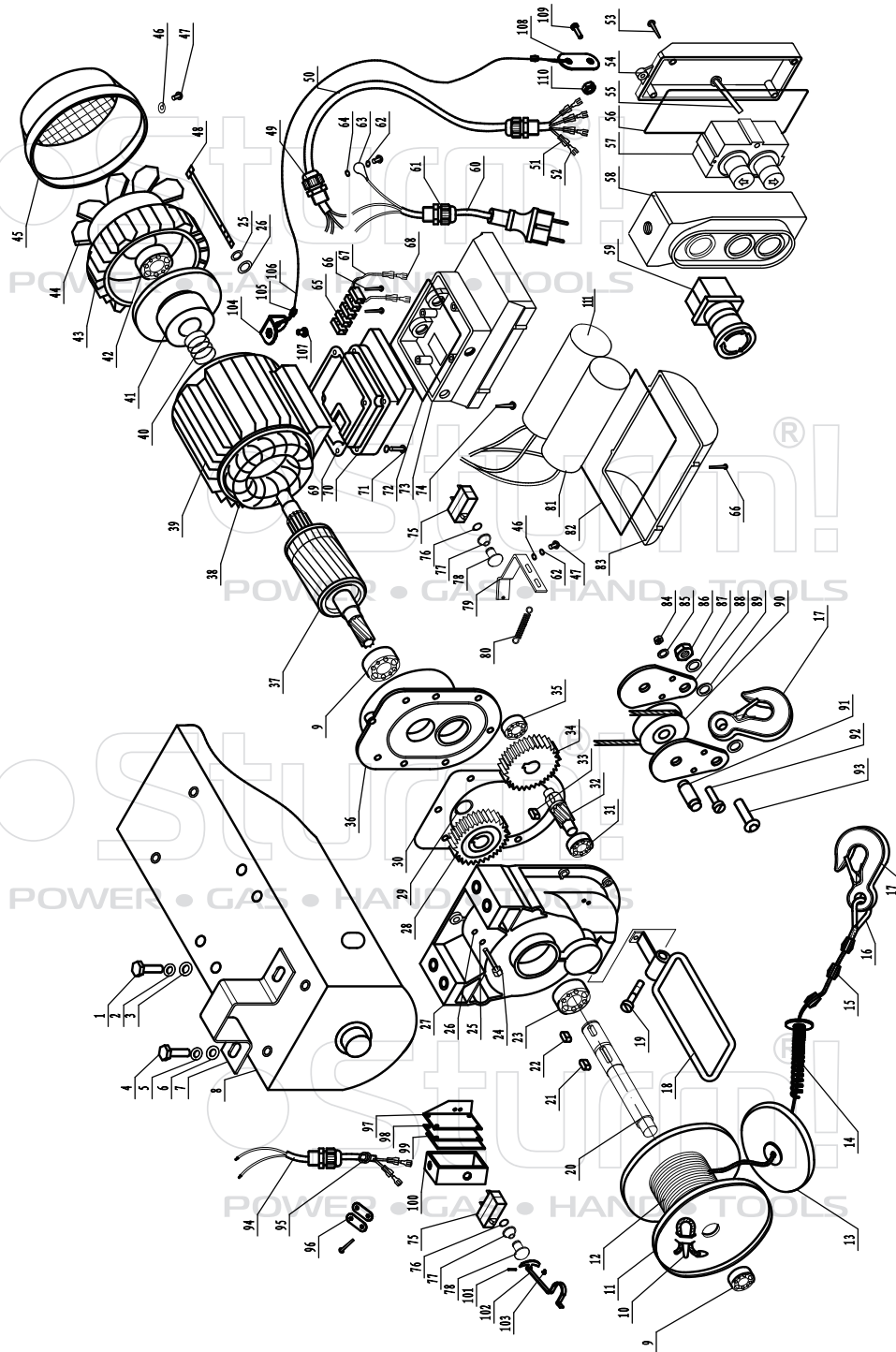

NO.	DESCRIPTION	NO.	DESCRIPTION
1	OUTER HEX BOLT	57	UP AND DOWN SWITCH
2	SPRING WASHER	58	UP COVER OF CONTROLLING HANDLE
3	WASHER	59	EMERGENCY STOP SWITCH
4	OUTER HEX BOLT	60	WATERPROOF PLUG AND CABLE LINE
5	WASHER	61	ANTI-KINK DEVICE OF CABLE LINE
6	SPRING WASHER	62	SPRING WASHER
7	FASTEN CLAMP	63	TERMINAL PIECE
8	HOUSING COVER	64	TOOTH WASHER
9	ROLLING BEARING 6204RZ	65	CONNECTION ENDING
10	ROPE PIN	66	CROSS PAN HEAD TAPPING SCREW
11	ROPE DRUM	67	GUIDING LINE
12	STEEL WIRE ROPE	68	PLUG-IN REED
13	BALANCE WEIGHT	69	LOWER AIRPROOF LOOP OF JUNCTION BOX
14	BUFFERING SPRING	70	LOWER COVER OF JUNCTION BOX
15	ALUMINUM BUCKLE	71	CROSS PAN HEAD SCREW
16	PROTECTIVE LOOP FOR STEEL WIRE ROPE	72	MIDDLE AIRPROOF LOOP OF JUNCTION BOX
17	HOOK	73	MIDDLE COVER OF JUNCTION BOX
18	POSITION LIMITED BRACKET	74	CROSS PAN HEAD TAPPING SCREW
19	SOCKET SCREW	75	POSITION LIMITED SWITCH
20	SOCKET SHAFT FOR ROPE DRUM	76	SNAP RING
21	FLAT KEY	77	BUTTON SPRING LOOP
22	FLAT KEY	78	POSITION LIMITED BUTTON
23	ROLLING BEARING 6205RZ	79	TIE-IN OF POSITION LIMITED SWITCH
24	SOCKET SCREW	80	REED OF POSITION LIMITED SWITCH
25	SPRING WASHER	81	CAPACITOR
26	WASHER	82	UP AIRPROOF LOOP OF JUNCTION BOX
27	GEAR BOX	83	UP COVER OF JUNCTION BOX
28	SMALL GEAR	84	LOCKNUT
29	SNAP RING	85	FLAT WASHER
30	PAPER WASHER	86	LOCKNUT
31	ROLLING BEARING 6201RZ	87	FLAT WASHER
32	GEAR DRIVING SHAFT	88	PULLEY PLYWOOD
33	FLAT KEY	89	PULLEY WASHER
34	BIG HELICAL GEAR	90	PULLEY
35	ROLLING BEARING 6203RZ	91	PULLEY SHAFT
36	FRONT HOUSING COVER	92	COLUMN NUT
37	ROTOR	93	OUTER HEX BOLT
38	STATOR	94	CABLE LINE
39	MOTOR HOUSING	95	RING
40	BRAKE SPRING	96	PLATE
41	BRAKE ASSEMBLY	97	FIXING PLATE
42	ROLLING BEARING 6203RZ	98	LOWER COVER OF DOWN LIMIT POSITION BOX
43	BACK HOUSING COVER	99	SEAL RING
44	FAN	100	UP COVER OF DOWN LIMIT POSITION BOX
45	FAN COVER	101	PIN
46	FLAT WASHER	102	DOWN LIMITED POSITION POLE
47	CROSS PAN HEAD SCREW	103	SPRING
48	OUTER HEX BOLT	104	BRACKETS ( BENDING )
49	ANTI-KINK DEVICE OF CABLE LINE	105	ALUMINUM BUCKLE
50	CABLE LINE	106	STEEL WIRE ROPE
51	PLUG-IN REED JACKET	107	CROSS PAN HEAD SCREW
52	PLUG-IN REED	108	BRACKETS ( STRAIGHT )
53	CROSS PAN HEAD TAPPING SCREW	109	CROSS PAN HEAD SCREW
54	LOWER COVER OF JUNCTION BOX	110	NUT
55	CROSS PAN HEAD TAPPING SCREW	111	CAPACITOR
56	AIRPROOF LOOP OF CONTROLLING HANDLE		