

# GC99372B

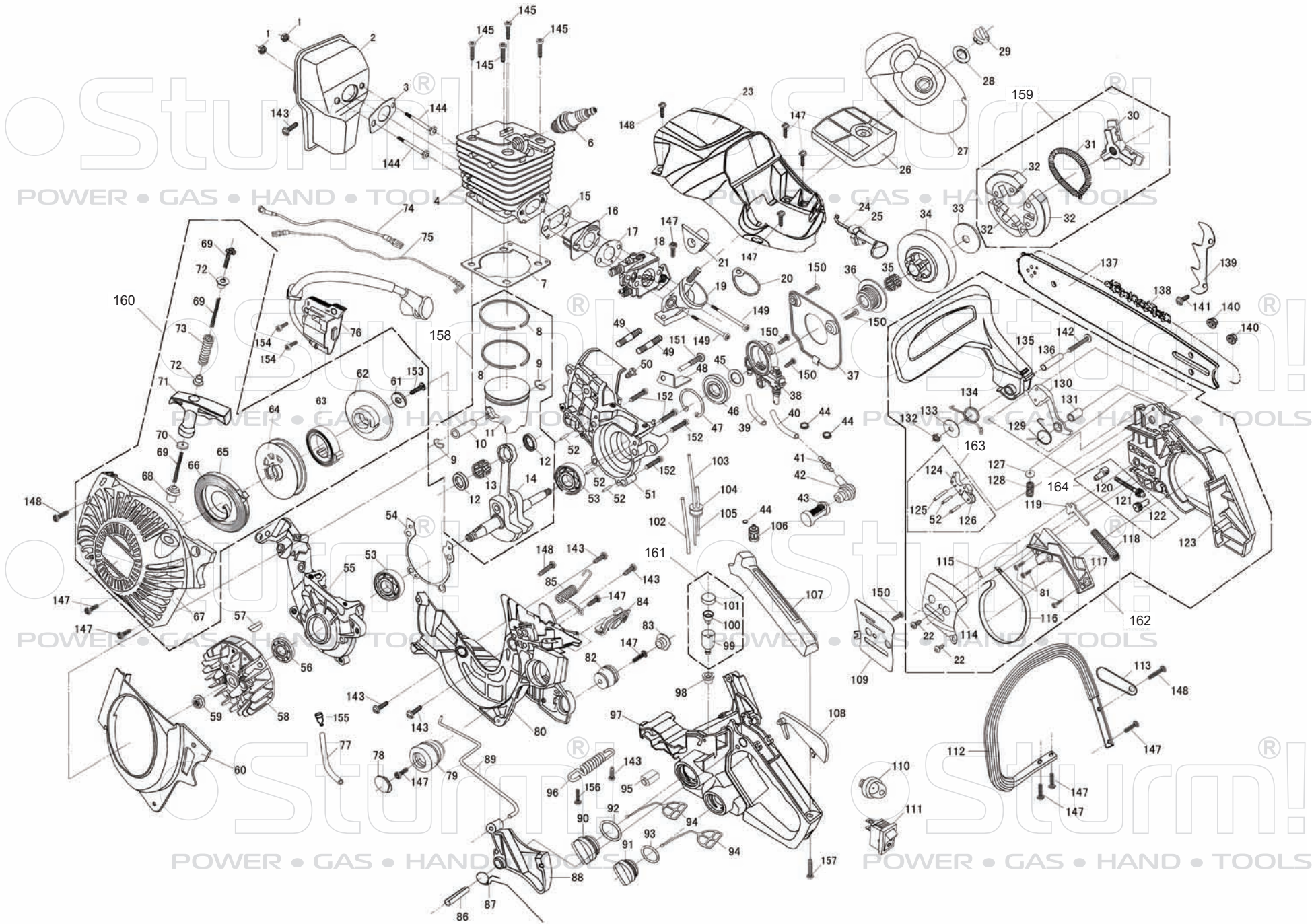

# GC99372B

NO.	DESCRIPTION	NO.	DESCRIPTION	NO.	DESCRIPTION
1	NUT	57	KEY-FLYWHEEL	112	HANDLE
2	MUFFLER ASSY	58	FLYWHEEL	113	PLATE
3	WASHER-MUFFLER	59	FLYWHEEL-NUT	114	PLATE-CHAIN ADJUSTING
4	CYLINDER	60	BAFFLE FAN	115	PIN
6	SPARK PLUG	61	WASHER	116	BAND BRAKE
7	WASHER-CYLINDER	62	PULLEY STARTER	117	SPRING PLATE
8	RING-PISTON	63	SPRING STARTER	118	SPRING
9	RING-SNAP	64	PULLEY STARTER	119	CONTROL ROD
10	PIN-PISTON	65	SPRING STARTER CASE	120	PIN
11	PISTON	66	SPRING STARTER	121	SCREW CHAIN ADJUSTING
12	BEARING-NEEDLE RETAINER RING	67	STARTER COVER	122	SCREW CHAIN ADJUSTING
13	BEARING-NEEDLE	68	ROPE JACKET	123	RIGHT HOUSING
14	CRANK SHAFT AND PISTON PART ASSEMBLE	69	ROPE	124	MAIN LEVER
15	WASHER-INTAKE	70	WASHER-STARTER HANDLE	125	PIN
16	INTAKE BOOT	71	STARTER HANDLE	126	ASSISTANT LEVER
17	WASHER-CARBURETOR	72	RING HANDLE	127	SPRING SUPPORT
18	CARBURETOR ASSY	73	SPRING	128	SPRING
19	GROMMET-INNER	74	GROUND WIRE	129	SPRING
20	GASKET-AIR FILTER	75	STOP WIRE	130	HEAVY PUNCH
21	IDLING ADJUST COVER	76	IGNITION ASSY	131	CASING PIPE
22	SCREW	77	BREATHER TUBE	132	NUT
23	TOP COVER	78	PLUG PAD (SMALL)	133	SPRING PLATE
24	CHOKE KNOB	79	LONG PAD RUBBER	134	SPRING
25	SUPPORT-CHOKE KNOB	80	CRANK BASE	135	BRAKE
26	AIR FILTER	81	SCREW	136	PIPE
27	COVER-AIR FILTER	82	SHORT PAD RUBBER	137	GUIDE BAR
28	WASHER-NUT	83	PLUG PAD(BIG)	138	CHAIN
29	AIR FILTER NUT	84	SUPPORT -ROD THROTTLE	139	SPIKE
30	RETAINER	85	SPRING	140	NUT
31	CLUTCH SPRING	86	PIN	141	SCREW
32	HOOF	87	SPRING-TRIGGER	142	SCREW
33	WASHER-CLUTCH	88	TRIGGER	143	SCREW
34	DRUM-CLUTCH	89	ROD THROTTLE	144	BOLT
35	BEARING-NEEDLE	90	FUEL CAP	145	SCREW
36	WORM GEAR	91	OIL CAP	146	SCREW
37	COVER-OIL PUMP	92	GASKET FUEL CAP	147	SCREW
38	OIL PUMP ASSY	93	GASKET OIL CAP	148	SCREW
39	HOSE OIL OUTLET	94	HOLDING-OIL CAP	149	SCREW
40	HOSE OIL LETER	95	PAD RUBBER	150	SCREW
41	CONNECTER	96	SPRING	151	SCREW
42	NOZZLE	97	FUEL TANK	152	SCREW
43	OIL FILTER	98	SUPPORT-BALANCE	153	SCREW
44	RING SNAP	99	COVER-BALANCE	154	SCREW
45	WASHER-OIL PUMP	100	BALANCE VALVE BODY	155	ONE-WAY VALVE
46	BIG OIL SEAL	101	COVER-BALANCE	156	SCREW
47	RING SNAP	102	OIL INLET	157	SCREW
48	CHAIN STOP	103	FUEL HOSE	158	CRANK SHAFT AND PISTON PART ASSEMBLE
49	STUD	104	SUPPORT -OIL VACULOT	159	CLUTCH ASSY
50	OIL NOZZLE	105	OIL RETURN PIPE	160	STARTER ASSY
51	RIGHT CRANK CASE	106	FUEL FILTER ASSY	161	BALANCE ASSY
52	PIN	107	COVER-HANDLE	162	BRAKE ASSY
53	BEARING BALL 6201Z	108	LEVER-TRIGGER	163	LEVER ASSY
54	GASKET-CRANK CASE	109	PLATE-OIL HOLE	164	ADJUSTING TENSION ASSY
55	LEFT CRANK CASE	110	OIL VACULOT		
56	SMALL OIL SEAL	111	STOP SWITCH		