

### GT3508U

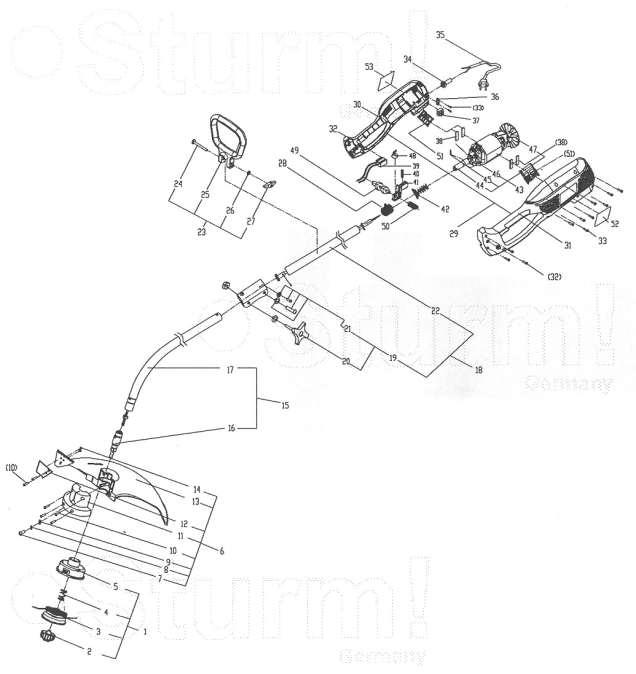

NO.	DESCRIPTION	NO.	DESCRIPTION
1	STRING HEAD ASSEMBLY		BUSHER WITH M4 SCREW HOLE
2	RETAINING CAP ASSEMBLY		COUPLER
	RETAINING CAP		M. SCREW M4X4 PRO COUPLER
	PLUG	23	FONT HANDLE ASSEMBLY
	BOLT	24	BOLT M6X50
3	SPOOL & STRING ASSEMBLY	25	FRONT HANDLE
	SPOOL	26	FLAT WASHER OD16XID6X1.5
	TWIST LINE 1.5MM	27	LOCK KNOBE
4	COMPRESSION SPRING	28	HOOK
5	TRIMME HEAD ASSEMBLY	29	HOUSING KITS
	STRING HOUSING	30	HOUSING SUPPORT
	EYELET	31	HOUSING COVER
6	GRASS DEFLECTOR ASSEMBLY	32	M. SCREW M4X10
7	M SCREW M5X12	33	ST SCREW 4.2X18
8	FLAT WASHER 5 ID.5MM OD.10MM	34	STRAIN RELIEF
9	SPRING WASHER 5 5	35	POWER CORD AND PLUG
10	SCREW M4X16	36	CORD CLAMP
11	SHIELD COVER	37	TERMINAL BOX
12	BLADE	38	RUBBER CUSHION
13	SHIELD ( CE )	39	MAIN SWITCH ASSEMBLY
14	NUT M4		MAIN SWITCH
15	LOWER TUBE ASSEMBLY		CONNECTED WIRE/ BROWN
16	BEARING ASSEMBLY		CONNECTED WIRE/ BLUE
	BEARING HOUSING	40	COMPRESSION SPRING
	FLAT WASHER OD15XID 9.8X1.0	41	SWITCH TRIGGER
	OUTPUT SHAFT	42	SPRING
	SHAFT BUSHER I	43	MOTOR KITS (44---47)
	SHAFT BUSHER II	44	MOTOR COUPLER
17	TUBE SUB-ASSEMBLY	45	SPRING PIN 3X16
	LOWR TUBE	46	MOTOR ASSEMBLY
	SPRING CLIP		FRONT BRACKET
	RIVET		REAR BRACKET
	SLEEVE FOR FLEX. SHAFT		BALL BEARING
	BUSHING FOR SLEEVE		ARMATURE
	FLEXIBLE SHAFT		FIELD
	COLLAR FOR FLEX. SHAFT		M. SCREW M5X95
18	UPPER TUBE ASSEMBLY		SPRING WASHER 5
19	KNOB & EXPAND-IT COUPLER ASSEMBLY		M. SCREW M3X10
20	EXPAND-IT COUPLER ASSEMBLY		SPRING WASHER 3
	KNOBE FOR EXPAND-IT COUPLER		FLAT WASHER 3
	EXPAND-IT		CARBON BRUSH HOLDER
	FLAT WASHER		CARBON BRUSH
	LOCKNUT		CARBON BRUSH TUBE
21	KNOB KITS		INDUCTOR
	SPRING WASHER 6MM 6MM		LEAD WIRE 1.0MM2/BROWN
	SCREW M5*12 M5*12		LEAD WIRE 1.0MM2/BLUE
	SCREW M5*6 M5*6	47	MOTOR FAN
	DENTIFORM WASHER DIAMETER 5MM	48	CAPACITOR
22	UPPER TUBE SUB-ASSEMBLY	49	BUTTON
	STRAIGHT TUBE ASSEMBLY	50	SPRING
	STAINGT TUBE	51	MOTOR BLOCK I
	FLEXIBLE SHAFT	(51)	MOTOR BLOCK II
	BUSHING FOR SLEEVE	52	BRAND LABEL
	SLEEVE FOR FLEX. SHAFT	53	RATING LABEL
	COLLAR FOR FLEX. SHAFT		

RU5120301