

ID2018MP

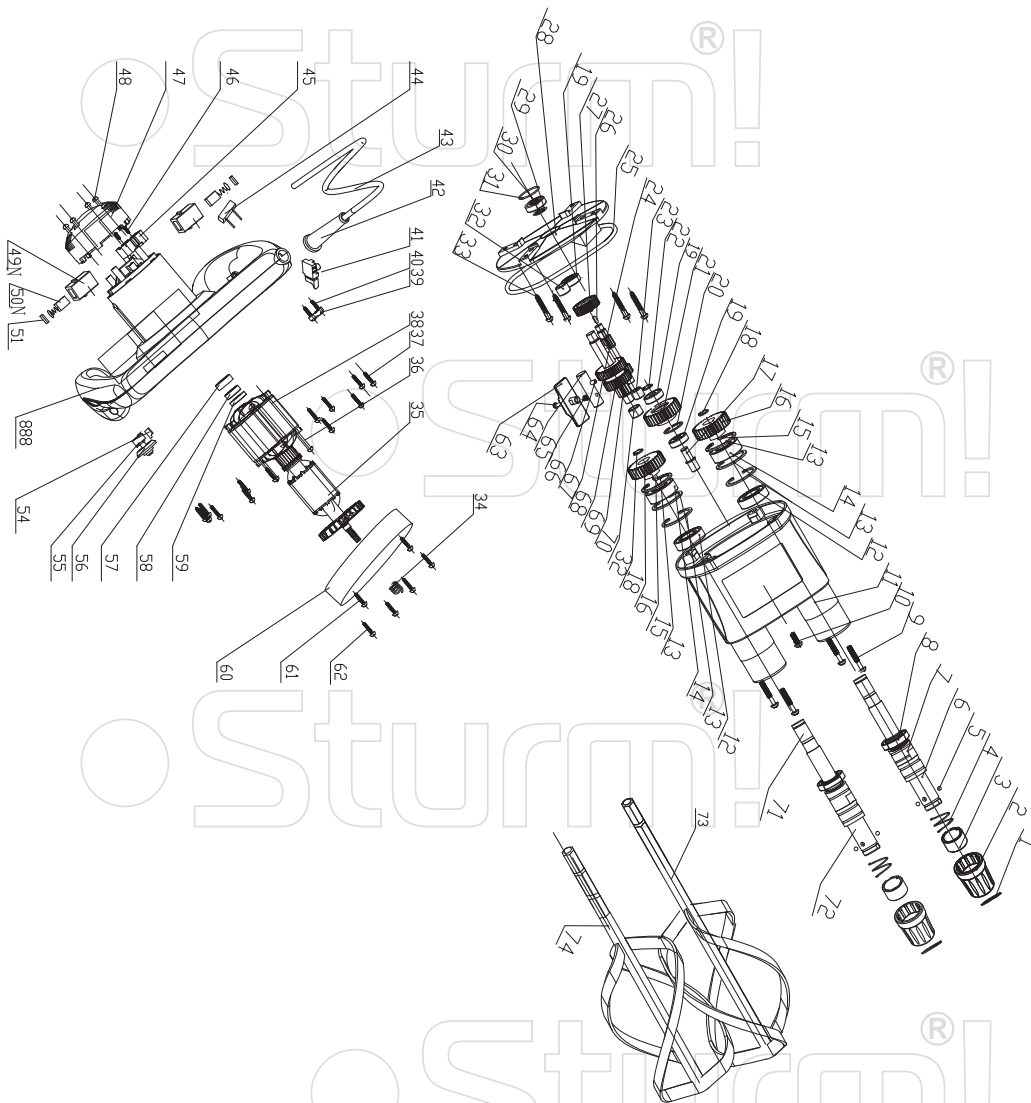

| NO. | DESCRIPTION | NO. | DESCRIPTION |
|-----|------------------------------------|-----|---------------------------------|
| 1 | ELASTIC COLLAR 20 | 38 | STATOR SUBASSEMBLY |
| 2 | COLLET OUTER COVER | 39 | CABLE PLATE |
| 3 | COLLET INNER SLEEVE | 40 | CROSSING TAPPING SCREW ST4X14-F |
| 4 | COLLET SPRING | 41 | SWITCH(FA2-6/2D-A1-B1-F3) |
| 5 | STEEL BALL 4.76 | 42 | CABLE SLEEVE |
| 6 | COLLET 1 | 43 | CABLE |
| 7 | OUTPUT SHAFT 1 | 44 | CAPACITANCE |
| 8 | OIL SEAL | 45 | INTEYRATING BLOCK |
| 9 | CROSS PAN HEAD SCREW M5X20 | 46 | CROSSING TAPPING SCREW ST3X10-F |
| 10 | CROSS ROUND HEAD SCREW M5X10 | 47 | BACK COVER |
| 11 | GEAR BOX | 48 | CROSSING TAPPING SCREW ST4X22-F |
| 12 | BEARING 6003-2Z | 49N | BRUSHHOLDER |
| 13 | ELASTIC COLLAR 35 | 50N | CARBON BRUSH |
| 14 | BEARING 6202-2Z | 51 | BRUSH COVER |
| 15 | KEY 5X12 | 54 | POTENTIOMETERS SLEEVE |
| 16 | BIG GEAR | 55 | POTENTIOMETER |
| 17 | IDLER SHAFT | 56 | POTENTIOMETER KNOB |
| 18 | ELASTIC COLLAR 15 | 57 | COVER OF BEARING 608-2Z |
| 19 | BEARING 608-2Z | 58 | BEARING 608Z |
| 20 | ELASTIC COLLAR 22 | 59 | MAGNETIC RING |
| 21 | IDLER | 60 | AIRFLOW COVER |
| 22 | ELASTIC COLLAR 8 | 61 | CROSSING TAPPING SCREW ST3X16-C |
| 23 | NEEDLE BEARING HK0810 | 62 | CROSSING TAPPING SCREW ST3X22C |
| 24 | MAIN DRIVING SHAFT | 63 | PUSHING BUTTON |
| 25 | PAPER PAD | 64 | PUSHING BUTTON FIXING SCREW |
| 26 | KEY 3X8 | 65 | SHIFT LEVER |
| 27 | DIAGONAL GEAR | 66 | PUSHING BUTTON SPRING |
| 28 | MIDDLE COVER | 67 | PIN |
| 29 | WOOLEN WASHER | 68 | KEY 5X45 |
| 30 | BEARING 609Z | 69 | TWOGANG GEAR |
| 31 | O-RING | 70 | VARIABLE SHAFT |
| 32 | NEEDLE BEARING HK1010 | 71 | OUTPUT SHAFT 2 |
| 33 | RCROSSING TAPPING SCREW ST4.8X55-F | 72 | COLLET 2 |
| 34 | MOTOR SPRING | 73 | MIXING PADDLE 1 |
| 35 | MOTOR SUBASSEMBLY | 74 | MIXING PADDLE 2 |
| 36 | CROSSING TAPPING SCREW ST5X65-F | 888 | HOUSING ASSEMBLE |
| 37 | CROSSING TAPPING SCREW ST4X18-F | | |

RU-ST20160902