

MS5525S

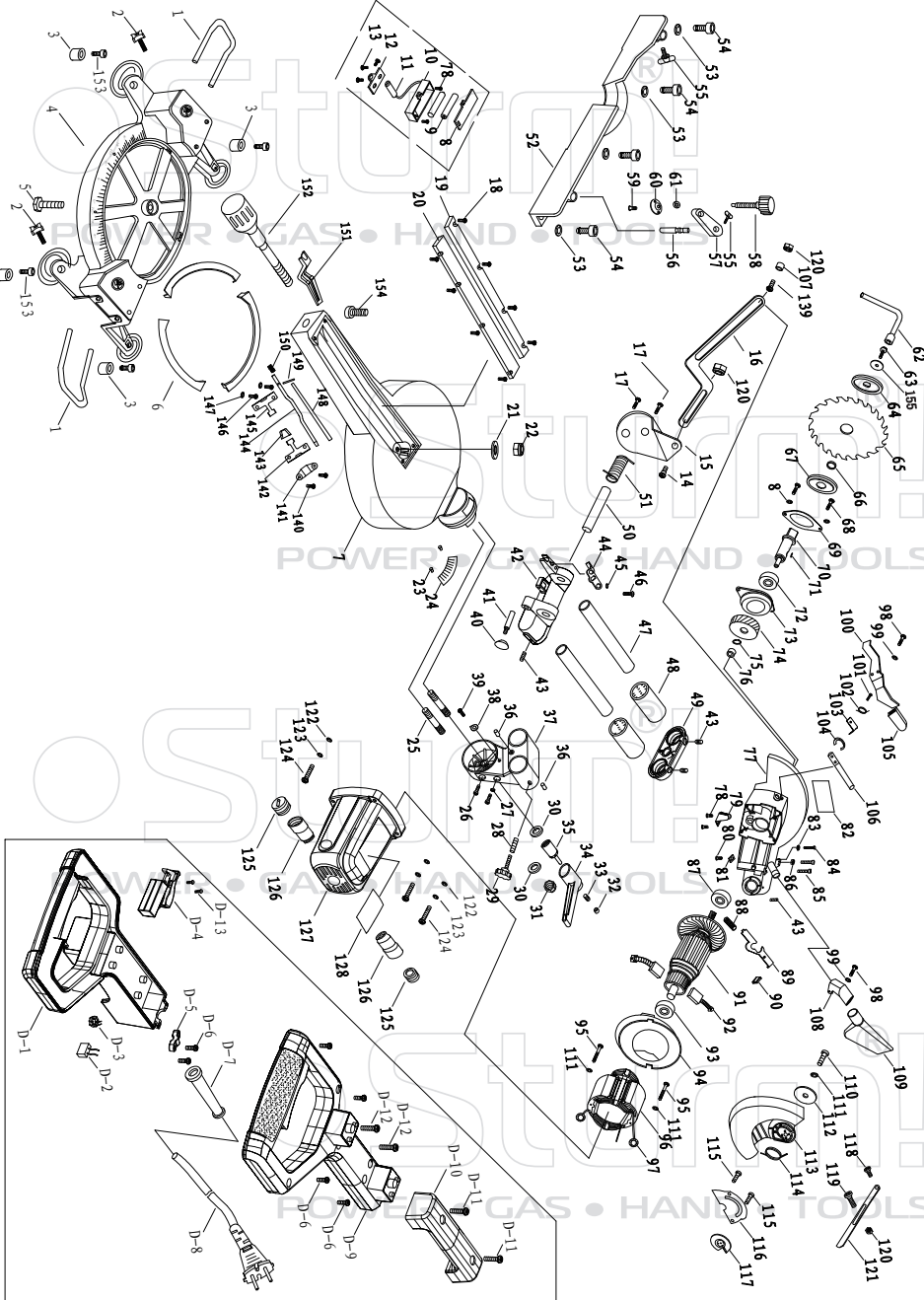

NO.	DESCRIPTION	NO.	DESCRIPTION	NO.	DESCRIPTION
1	EXT.BAR	54	PAN HD SCREW	107	DISTANCE SLEEVE
2	LOCK SCREW	55	WING SCREW	108	DUST CHUTE
3	RUBBER FOOT	56	LOCATING SHAFT	109	DUST BAG
4	BASE	57	LOCK ROD	110	SCREW
5	HEX SCREW	58	LOCK KNOB	111	SPRING WASHER
6	TABLE STEEL SHEET	59	PAN BOSS SCREW	112	WASHER
7	ROTATING TABLE	60	CLAMP PLATEN	113	LOWER GAUDE
8	BATTERY BOX COVER	61	FLAT WASHER	114	TORSIONAL SPRING
9	BATTERY	62	HEX WRENCH	115	PAN HD SCREW
10	BATTERY BOX	63	HEX SCREW	116	SPRING PLATE
11	LASER	64	OUTER FLANGE	117	LOCATING PLATE
12	LASER SEAT	65	SAW BLADE	118	ABNORMITY SCREW1
13	PAN HEAD SCREW	66	LOCATING RING	119	ABNORMITY SCREW2
14	PAN HD UNSTANDARD SCREW	67	INNER FLANGE	120	LOCK NUT
15	LINK BRACKET	68	PAN HD SCREW	121	LINK
16	LINK	69	BEARING CAP	122	FLAT WASHER
17	SCREW	70	OUTPUT SHAFT	123	SPRING WASHER
18	PAN HD SCREW	71	LUNE KEY	124	PAN HD SCREW
19	KERF BROAD(SMALL)	72	BEARING 6203	125	BRUSH HOLDER CAP
20	KERF BROAD(BIG)	73	BEARING HOUSING	126	BRUSH HOLDER
21	FLAT WASHER	74	GEAR	127	MOTOR HOUSING
22	LOCK NUT	75	EXTERNAL CIRCLIP	128	TABLE II
23	RIVET	76	NEEDLE ROLLER BEARING	139	FLAT HD SCREW
24	SCALE	77	UPPER GUARD	140	PAN HD SCREW
25	DOUBLE END STUD	78	SCREW	141	SUPPORT SEAT
26	HEX HD SCREW	79	GUARD BAFFLE PLATE	142	SPRING STEEL I
27	NUT	80	SCREW	143	STEEL JACKET
28	SPRING	81	RUBBER BAFFLE PLATE	144	ROTATION LOCATION PIN
29	LOCK HANDLE	82	LABEL I	145	SPRING STEEL II
30	BIG FLAT WASHER	83	DEPTH ADJUSTABLE NUT	146	PAN HD SCREW
31	LOCK NUT	84	HEX HD BOLT	147	SPRING WASHER
32	AXIES PIN CAP	85	HEX HD SCREW	148	ROTATION LOCKING PIN
33	LOCK SPRING	86	NUT	149	LOCKING COTTER
34	LOCK HANDLE	87	BEARING 6202	150	SPRING
35	AXIES PIN NUT	88	CENTURY SPRING	151	LOCKING SHIFTER
36	RUBBER STOP POLE	89	PULL ROD	152	ROTATION LOCKING HANDLE
37	BRACKET	90	JACKET	153	INNER HEX SCREW
38	BEVEL POINTER	91	ROTOR	154	ROTATION FOOT
39	PAN HD SCREW	92	CARBON BRUSH	155	WASHER
40	SELF-LOCK CAP	93	BEARING 6000	D--1	HANDLE
41	SELF-LOCK PIN	94	FAN SHROUD	D--2	CAPACITANCE
42	BRACKET JOINT	95	PAN HD TAPPING SCREW	D--3	INDUCTANCE
43	HEX LOCK SCREW	96	STATOR	D--4	SWITCH
44	DEPTH ADJUSTABLE BLOCK	97	JUMPER WIRE	D--5	CORD CLAMP
45	WAVE WASHER	98	PAN HD SCREW	D--6	PAN HD TAPPING SCREW
46	BUTTON HD BOSS SCREW	99	SPRING WASHER	D--7	CABLE SLEEVE
47	GUIDE PIPE	100	SELF-LOCK TRIGGER	D--8	CABLE & PLUG
48	LINEAR BEARING	101	PAN HD SCREW	D--9	HANDLE COVER
49	REAR COVER	102	TRIGGER SPRING	D--10	LIFT HANDLE
50	PIVOT PIN	103	SPRING SEAT	D--11	PAN HD TAPPING SCREW
51	TORSIONAL SPRING	104	CRACK CIRCLIP	D--12	PAN HD SCREW
52	FENCE	105	RUBBER JACKET	D--13	PAN HD SCREW
53	SPRING WASHER	106	CONNECTION ROD		