

Sturm![®]
POWER • GAS • HAND • TOOLS

Sturm![®]
POWER • GAS • HAND • TOOLS

Sturm![®]
POWER • GAS • HAND • TOOLS

Sturm![®]
POWER • GAS • HAND • TOOLS

Sturm![®]
POWER • GAS • HAND • TOOLS

Sturm![®]
POWER • GAS • HAND • TOOLS

Sturm![®]
POWER • GAS • HAND • TOOLS

Sturm![®]
POWER • GAS • HAND • TOOLS

PG87281

NO.	DESCRIPTION	NO.	DESCRIPTION
1	FUEL TANK COVER	37	HEX. FLANGE BOLT
2	FUEL TANK SEAL	38	FLAT WAHSER
3	FILTER SCREEN	39	HEX. FLANGE BOLT
4	FUEL GAUGE (INDICATOR)	40	BACK COVER
5	HEX. FLANGE BOLT	41	HEX. FLANGE BOLT
6	FLAT WASHER	42	HEX. FLANGE BOLT
7	BUSH	43	COLLAPSIBLE BEAM
8	FUEL TANK CUSHION	44	PANEL
9	FUEL TANK	45	SWITCH
10	FUEL TANK SWITCH FILTER SCREEN	46	POWER INDICATOR
11	FUEL TANK SWITCH SEAL	47	LOW OIL ALERT LIGHT
12	NUT	49	VOLTMETER
13	FUEL TANK SWITCH ASSEMBLY	50	BREAKER
14	FUEL PIPE CLAMP	52	DC PROTECTOR
15	FUEL PIPE	53	DC SOCKET
16	FLAME	54	EURO STYLE SOCKET
17	ENGINE	55	NUT
18	AIR FILTER BRACKET	56	SPRING WASHER
19	HEX. FLANGE BOLT	57	FLAT WAHSER
20	MUFFLER SEAL	58	HEX. FLANGE BOLT
21	MUFFLER ASSEMBLY	59	PANEL
22	SPRING WASHER	60	BOLT
23	HEX. FLANGE BOLT	62	PANEL REAR COVER
24	HEX. FLANGE BOLT	63	CORD SHEATH
25	MUFFLER GUARD	64	NUT
26	HEX. FLANGE BOLT	65	SMALL CUSHION PAD
27	MUFFLER SUPPORT BRACKET	66	FLAT WAHSER
28	ROTOR	67	SPRING WASHER
29	STATOR WINDING	68	BIG CUSHION PAD
30	MOTOR REAR COVER	69	FLAME STAND
31	RECTIFIER	70	FLAT WAHSER
32	HEX. FLANGE BOLT	71	NUT
33	CARBON BRUSH ASSEMBLY		
34	CONNECTION BLOCK		
35	HEX. FLANGE BOLT		
36	AVR		

ST20131126

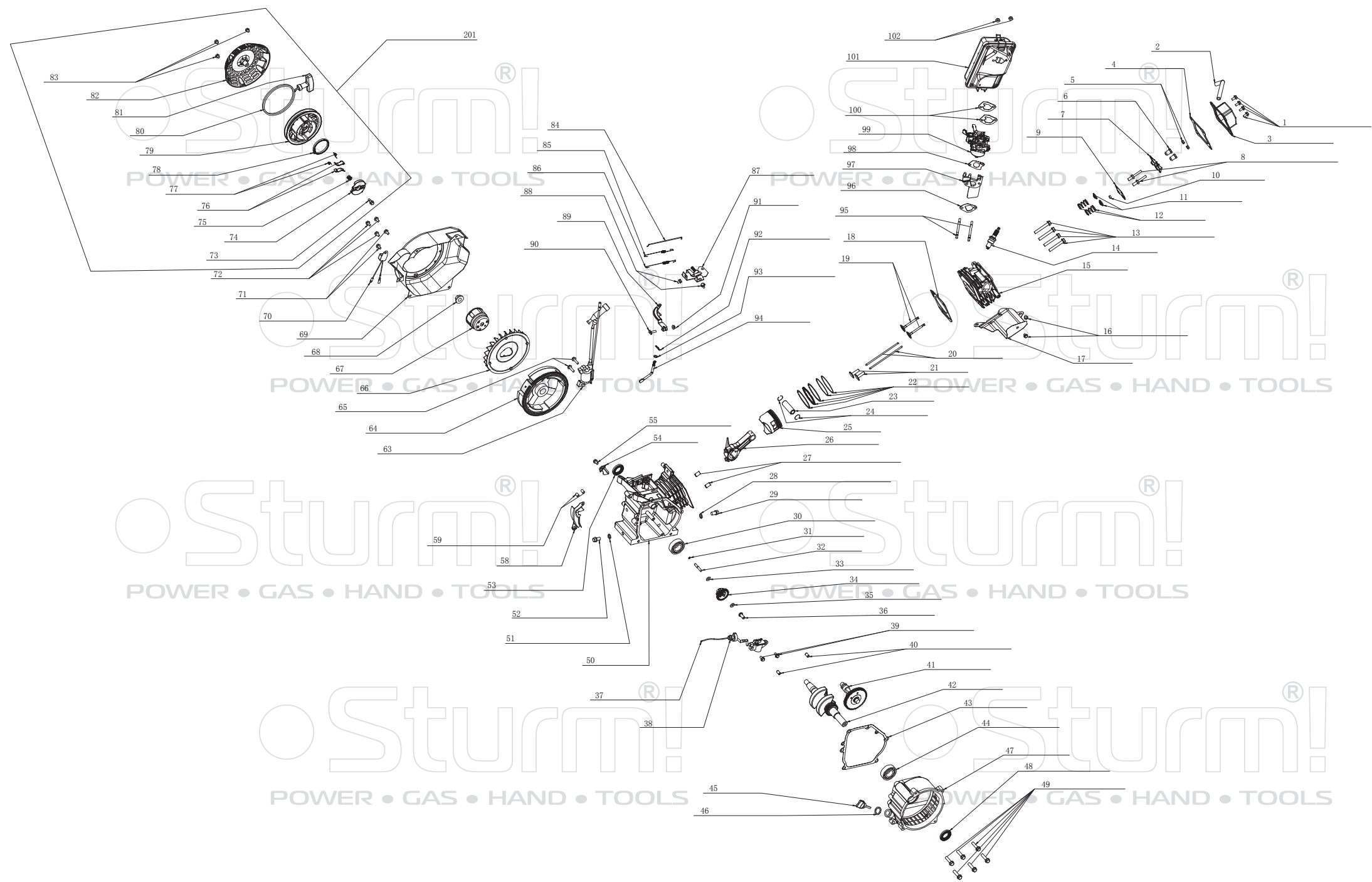

ENGINE FOR PG87281

NO.	DESCRIPTION	NO.	DESCRIPTION
1	HEX. FLANGE BOLT	53	OIL SEAL
2	RIGHT-ANGLE WASTE PIPE	54	PRESSURE BOARD
3	CYLINDER HEAD COMP	55	HEX. FLANGE BOLT
4	CYLINDER HEAD SEAL	58	FLY WHEEL GUARD
5	VALVE CLEARANCE ADJUSTING NUT	59	MOTOR ASSY POSITION PIN
6	VALVE ARM NUT	63	IGNITION COIL ASSY
7	VALVE ARM	64	FLY WHEEL WITH GEAR
8	BOLT	65	HEX. FLANGE BOLT
9	LEVER BRACKET	66	FAN
10	VALVE HEAD CAP	67	START COVER
11	VALVE SPRING BASE	68	NUT
12	VALVE SPRING	69	FAN COVER
13	BOLT	70	ONE-WAY CONDUCTOR ASSY
14	SPARK PLUG	71	HEX. FLANGE BOLT
15	CYLINDER HEAD	72	HEX. FLANGE BOLT
16	HEX. FLANGE BOLT	73	PRESSURE BOARD SCREW
17	DOWN WINDING GUARD	74	PRESSURE BOARD
18	CYLINDER HEAD SEAL GASKET	75	PRESSURE BOARD SPRING
19	INTAKE AND EXHAUST VALVE	76	RATCHET
20	LEVER ASSEMBLY	77	RATCHET SPRING
21	LITER	78	SPRING
22	PISTON RING ASSY	79	RECOIL STARTER REEL
23	PISTON PIN	80	PULLING CORD
24	PISTON PIN CIRCLIP	81	HANDLE
25	PISTON	82	REEL COVER
26	CONNECTION ROD ASSY	83	HEX. FLANGE BOLT
27	VALVE HEAD POSITION PIN	84	GOVERNOR ROD
28	OIL DRAIN BOLT WASHER	85	TRIMMING SPEED SPRING
29	OIL DRAIN BOLT	86	RESET SPRING
30	DEEP GROOVE BALLING BEARING 6205	87	GOVERNOR BASE ASSY
31	CIRCLIP FOR SPEED ADJUSTING SHAFT	88	HEX. FLANGE BOLT
32	SPEED ADJUSTING SHAFT	89	GOVERNOR ARM
33	WASHER	90	T-SHAPED BOLT
34	SPEED GEAR ASSY	91	NUT
35	WASHER	92	GOVERNOR ROD PIN CLAMP
36	SPEED ADJUSTING SHAFT BUSH	93	WASHER
37	OIL SENSOR ASSY	94	GOVERNOR ROD CLAMP
38	NUT	95	STUD BOLT
39	HEX. FLANGE BOLT	96	INTAKE WASHER
40	CRANKCASE POSITION PIN	97	CARBURETOR HEAT INSULATOR
41	CAMSHAFT ASSY	98	(OUT) CARBURETOR WASHER
42	CRANK ASSY	99	CARBURETOR ASSEMBLY
43	CRANKCASE PAPER WASHER	100	(IN) CARBURETOR WASHER
44	DEEP GROOVE BALLING BEARING 6205	101	AIR FILTER ASSEMBLY
45	OIL LEVEL CAP ASSEMBLY	102	NUT
46	OIL LEVEL SEAL	201	RECOIL STARTER
47	CRANKCASE HIGH COVER		
48	OIL SEAL		
49	HEX. FLANGE BOLT		
50	CRANKCASE		
51	OIL DRAIN BOLT WASHER		
52	OIL DRAIN BOLT		