

PG8D19W

Germany

Germany

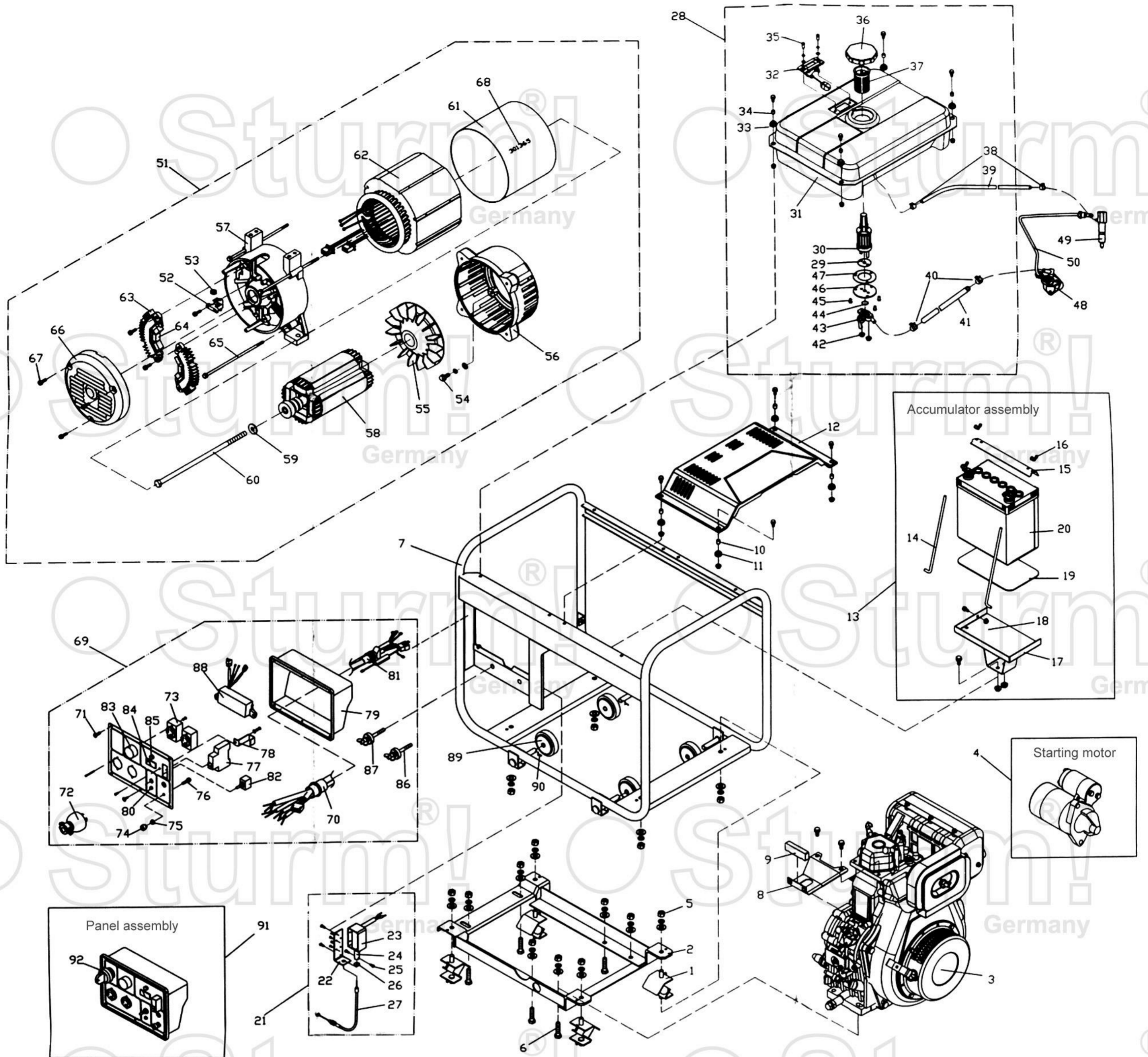

No.	Description	Qty.	No.	Description	Qty.	No.	Description	Qty.
1	cushion	4	32	oil mark unit	1	63	rectifier and radiator	2
2	house base weldment assembly	1	33	cushion	4	64	rectifier	6
3	air-cooled diesel	1	34	sheath	4	65	bolt M6*175	4
4	starting motor	1	35	screw M5*12	2	66	the rare cover	1
5	nut10	14	36	fuel tank cap joint assembly	1	67	self-tapping screw	3
6	bolt M10*40	6	37	fuel filler screen	1	68	generator serial number assembly	1
7	housing weldment assembly	1	38	fuel return pipe clip	2	69	panel assembly	1
8	engine assistant support frame	1	39	fuel return pipe	1	70	wiring harness fixed sheath	1
9	assistant support frame cushion	1	40	fuel pipe clip	2	71	screw M6*16	4
10	sheath	4	41	fuel pipe	1	72	single-phrase pin	2
11	cushion	4	42	nut M6	2	73	single-phrase receptacle	2
12	decorate plate assembly	1	43	fuel tank switch assembly	1	74	grounding screw cap	1
13	accumulator assembly	1	44	O-RING	1	75	nut M6	1
14	screw bolt	2	45	SCREW	3	76	bolt M6*20	1
15	accumulator pressure plate	1	46	seal plate	1	77	air switch	1
16	wing nut M6	2	47	seal washer	1	78	air switch setting plate	1
17	accumulator support weldment assembly	1	48	fuel pump	1	79	instruction box rare cover	1
18	nut M6	1	49	nozzle	1	80	oil alerting indicator lamp	1
19	accumulator washer	1	50	high-pressure fuel pipe	1	81	circuitry setting sheath	1
20	accumulator 12v	1	51	electric machine assembly	1	82	knob switch	1
21	electromagnet assembly	1	52	carbon brush	1	83	potentiometer(current adjustment)	1
22	electromagnet setting plate	1	53	current mutual induction device	1	84	voltmeter	1
23	electromagnet	1	54	bolt M8*20	4	85	running indicator light	1
24	iron-corn	1	55	fan	1	86	anode wiring terminal	1
25	screw M5*8	2	56	forepart cover	1	87	cathode wiring terminal	1
26	electromagnet washer	1	57	back-end cover	1	88	welding & generating AVR	1
27	flexible shaft unit	1	58	rotator assembly	1	89	truckle	4
28	fuel tank assembly	1	59	pull-through shaft bolt washer	1	90	cotter pin	4
29	seal washer	1	60	pull-through hexagon bolt	1	91	panel assembly	1
30	element assembly	1	61	electric machine safeguard plate	1	92	starting key	1
31	fuel tank weldment assembly	1	62	stator assembly	1			

Germany