

PL4615S

NO.	DESCRIPTION	NO.	DESCRIPTION	NO.	DESCRIPTION
1	Inch hex flange bolts	31	Side discharge cover bracket	61	Catcher bottom
2	blade washer	32	Self tapping screw	62	Lock washer
3	2pcs Swing blade	33	Self-lock device base	63	Rear discharge cover shaft
4	Blade Adapter Assy	34	Self-lock device spring	64	Rear discharge cover spring
5	Hexagon head bolts	35	Self-lock device limit	65	Rear discharge cover dust proof
6	Hex flange bolts	36	Self-lock device base washer	66	Rear discharge cover
7	Belt cover	37	Cross recessed pan head tapping screw	67	Catcher Top
8	Phillips flat head self tapping screw	38	Outter cover of hub	68	Catcher Screen
9	Bolt	39	Wheel assy	69	Foam pipe
10	Self-locking nut	40	Inner cover of hub	70	Self-propelled Lever
11	deck welding assy.	41	Front drive bushing	71	Upper handle
12	Hieght Adjustment Rod Spring	42	Wave washer	72	Lever block
13	Height Adjustment Rod	43	Front drive assy.	73	Bolt
14	R type pin	44	V belt	74	Rope Guide
15	Self-locking nut	45	Self-propelled spring	75	Cap nut
16	Hex flange bolts	46	Belt limit lever	76	Quick fix knob
17	Left handle bracket	47	GT Transmission	77	Pin
18	Petrol engine	48	Ratchet pin	78	Quick knob lever
19	Outlet pipe	49	Rear drive bushing	79	Knob lever fix
20	Inlet pipe	50	Ratchet washer	80	Lower handle
21	"O" ring	51	Spring washer	81	Half round head square neck bolts
22	Cable Block	52	Ratchet Wheel L	82	Flat washer
23	Mulching plug	53	Rear drive fix plate R	83	3# triangle knob
24	Height Adjustment plate	54	Rear drive fix plate L	84	Hexagon nut
25	Left handle bracket	55	Ratchet Wheel R	85	Cable clip
26	Half round head square neck bolts	56	Outer cover of hub	86	5# triangle knob
27	Side discharge cover shaft	57	Wheel assy.	87	Brake cable
28	Side discharge cover spring	58	Inner cover of hub	88	Self-propelled cable
29	Side discharge cover	59	Rear drive assy.	89	Cable fix base
30	Side discharge chute	60	Height adjustment ball	90	Brake lever

UK-ST20200915

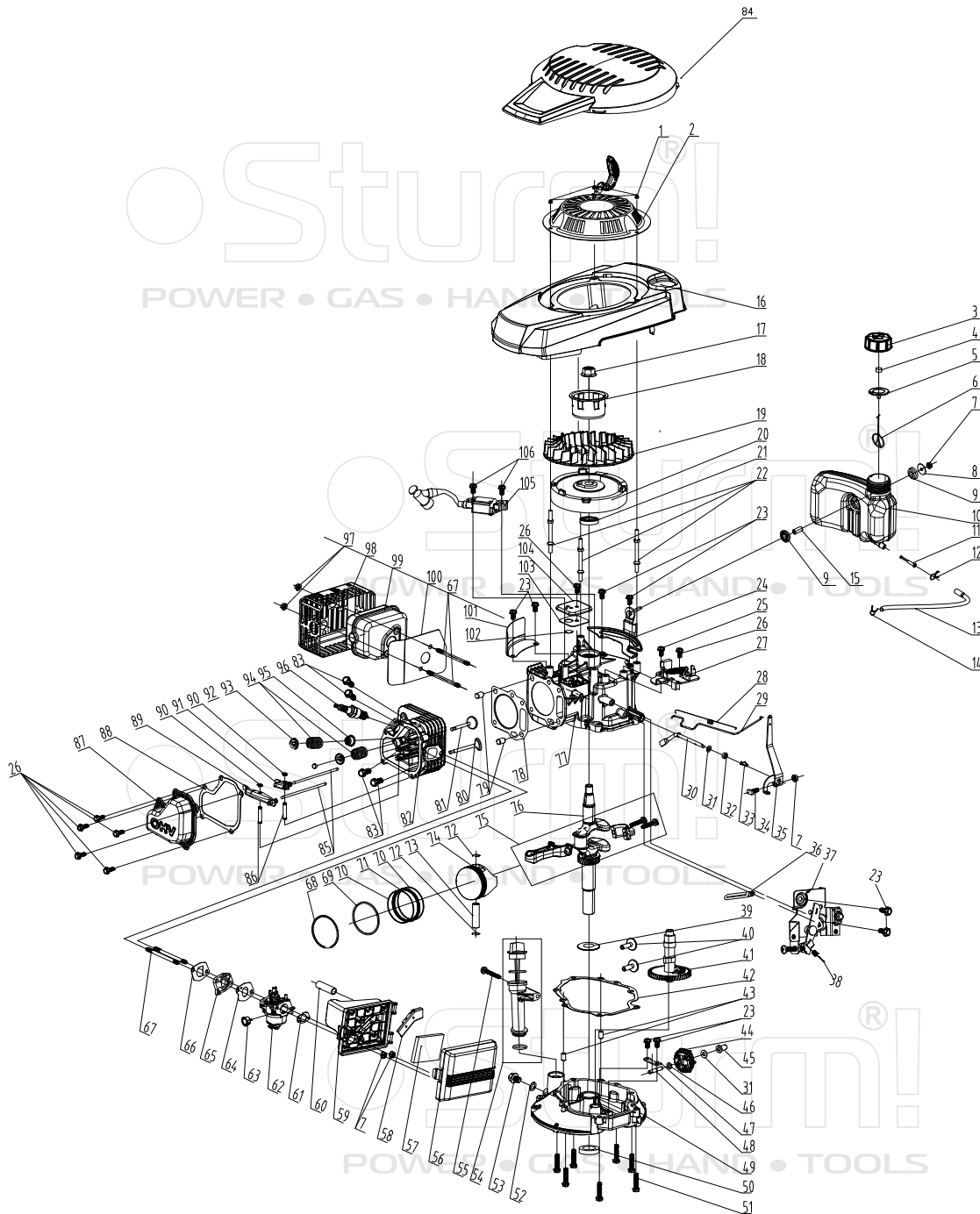

Sturm!

POWER • GAS • HAND • TOOLS

ENGINE FOR PL4615S

NO.	DESCRIPTION	NO.	DESCRIPTION	NO.	DESCRIPTION
1	Cap nut	36	clip	71	Bushing Ring
2	pull starter assy.	37	throttle assy.	72	piston pin
3	fuel tank cap	38	throttle control spring	73	Piston Pin circlip
4	fuel tank cap sponge	39	clockwise gear gasket	74	Piston
5	Fuel Tank Cap seal gasket	40	pin	75	connecting rod assy.
6	connect cable of fuel cap	41	camshaft assy.	76	crankshaft assy.
7	Hex flange nuts	42	Respirator head gasket	77	crankshaft box assy.
8	The oil tank mount big washer	43	spacing pin	78	Cylinder head gasket
9	Tank damping rubber pad	44	rete-limiting gear assy.	79	spacing pin
10	fuel tank body	45	Sliding Sleeve	80	IntakeValve
11	Filtering Net Duct of Fuel	46	Gasket	81	Exhaust Valve
12	fuel pipe lock clamp I	47	rate-limiting gear shaft clamp	82	cylinder head assy.
13	fuel pipe	48	rate-limiting gear shaft	83	locking bolt
14	fuel pipe lock clamp II	49	Crank box cover	84	engine cover
15	Fuel tank mounting bushing	50	oil seal	85	push rod
16	The transparent cover	51	Bolt	86	Valve rocker shaft
17	Hex flange nuts	52	Oil drain bolt gasket	87	cylinder head cover
18	starter hub	53	Oil drain bolt	88	Cylinder head gasket
19	fan	54	Lubricating Gauge Assy	89	Exhaust valve rocker combination
20	flywheel assy	55	Bolt	90	washer
21	oil seal	56	Air Filter Cover	91	Air intake door rocker combination
22	Dual-head bolts	57	Foam filter	93	Spring Coil of Intake Valve
23	Bolt	58	Vent groove cover plate	94	valve spring
24	main bracket of fuel tank	59	An air filter base.	95	oil seal assy
25	Bolt	60	waste pipe	96	spark plug
26	Bolt	61	Air filter paper pad	97	Self-locking nut
27	detent assy.	62	Carburetor	98	muffler cover assy.
28	Pull Spring for Pull Rod	63	prime button II	99	muffler assy.
29	Handspike of Valve	64	Carburetor paper pad II	100	Muffler insulating pad
30	rate-limiting rocker arm shaft	65	Air Inlet Pipe	101	wind shield
31	Gasket	66	Carburetor paper pad I	102	Respirator valve plate
32	oil seal	67	Dual-head bolts	103	Respirator head gasket
33	R type pin	68	Piston Ring I	104	Valve rocker shaft
34	bolt	69	Piston Ring II	105	ignition assy.
35	throttle rocker arm	70	Guide Rail	106	Bolt

UK-ST20200915