

## PL4642

NO.	DESCRIPTION	NO.	DESCRIPTION	NO.	DESCRIPTION
1	Foam pipe	24	3# triangle knob	47	Hexagon head bolts
2	Upper handle	25	Outer cover of hub	48	"O" ring
3	Brake lever	26	Self-locking nut	49	Inlet pipe
4	Lever block	27	Wheel Assy.	50	Outlet pipe
5	Hex lock nut	28	Height adjustment ball	51	Board for Height Adjuster
6	Cable fix base	29	Wave washer	52	Fabric grass bag
7	Bolt	30	Rear drive assy.	53	Phillips flat head self tapping screw
8	Brake cable	31	R type pin	54	Blade washer
9	Rope Guide	32	Bolt	55	Catcher Top
10	Cap nut	33	Flat washer	56	Catcher window
11	Cable clip	34	Height Adjustment Rod	57	Catcher top protection board
12	Lower handle	35	Deck assy.	58	Catcher frame
13	Pin	36	Cable block	59	Lock washer
14	Quick knob	37	Bolt	60	Rear discharge cover
15	Quick knob lever	38	Half round head square neck bolts	61	Cover spring
16	Knob lever fix	39	Left bracket	62	Rear discharge cover shaft
17	Handle block	40	Rear discharge base	63	Wheel assy.
18	5# triangle knob	41	Large flat washer	64	Front drive assy.
19	Hexagon nut	42	Phillips flat head self tapping screw	65	Blade Adapter
20	Flat knob	43	Rear discharge cover support	66	Bar blade
21	Flat washer	44	Right bracket	67	Blade washer
22	Half round head square neck bolts	45	Petrol engine	68	Inch hex flange bolts
23	Half round head square neck bolts	46	Square Gas	69	Split Washer $\phi 5$

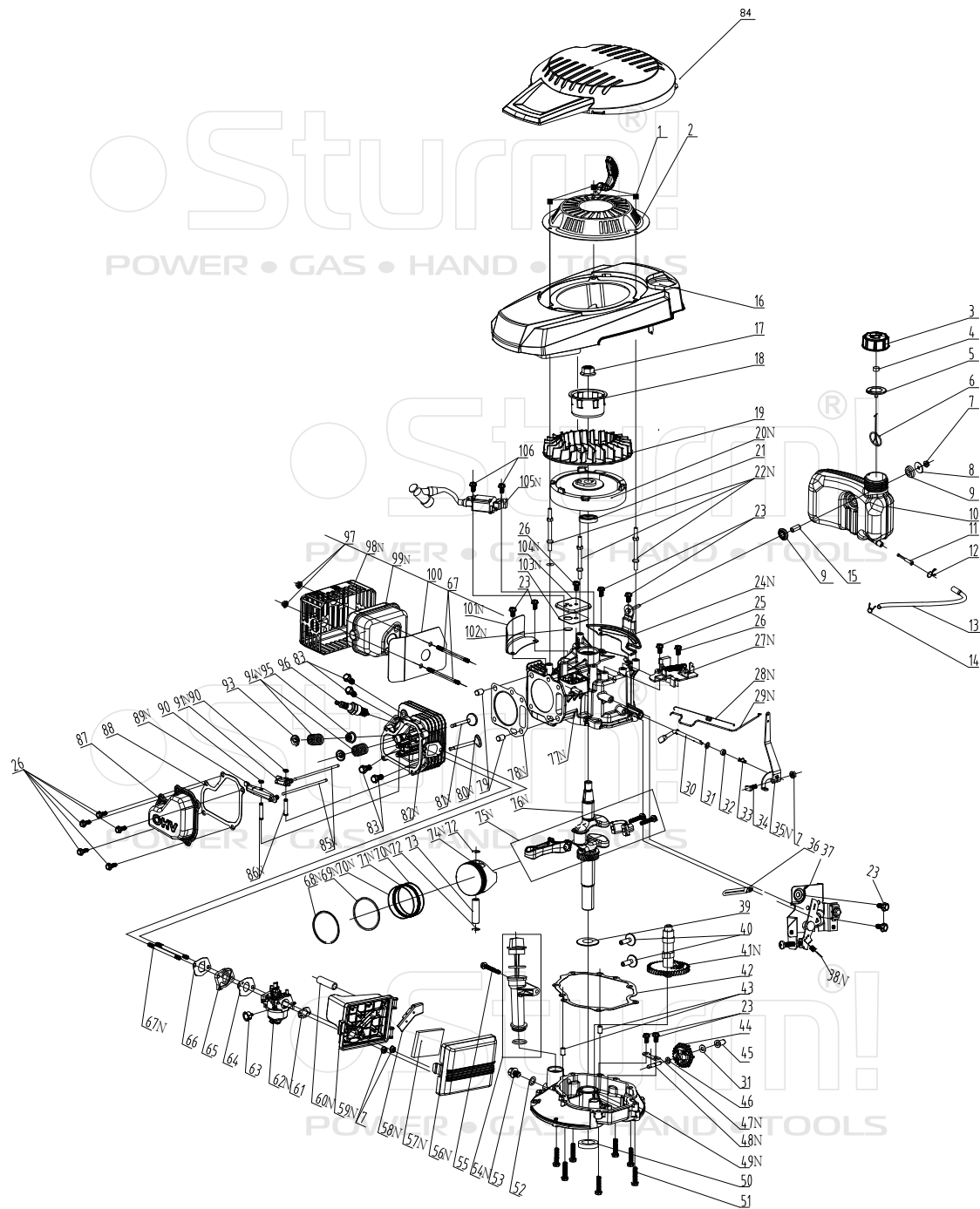

## ENGINE FOR PL4642

NO.	DESCRIPTION	NO.	DESCRIPTION	NO.	DESCRIPTION
1	Cap nut	36	clip	71N	Bushing Ring
2	pull starter assy.	37	throttle assy.	72	piston pin
3	fuel tank cap	38N	throttle control spring	73	Piston Pin circlip
4	fuel tank cap sponge	39	clockwise gear gasket	74N	Piston
5	Fuel Tank Cap seal gasket	40	pin	75N	connecting rod assy.
6	connect cable of fuel cap	41N	camshaft assy.	76N	crankshaft assy.
7	Hex flange nuts	42	Respirator head gasket	77N	crankshaft box assy.
8	The oil tank mount big washer	43	spacing pin	78N	Cylinder head gasket
9	Tank damping rubber pad	44	rete-limiting gear assy.	79	spacing pin
10	fuel tank body	45	Sliding Sleeve	80N	Intake Valve
11	Filtering Net Duct of Fuel	46	Gasket	81N	Exhaust Valve
12	fuel pipe lock clamp I	47N	rate-limiting gear shaft clamp	82N	cylinder head assy.
13	fuel pipe	48N	rate-limiting gear shaft	83	locking bolt
14	fuel pipe lock clamp II	49N	Crank box cover	84	engine cover
15	Fuel tank mounting bushing	50	oil seal	85N	push rod
16	The transparent cover	51	Bolt	86N	Valve rocker shaft
17	Hex flange nuts	52	Oil drain bolt gasket	87	cylinder head cover
18	starter hub	53	Oil drain bolt	88	Cylinder head gasket
19	fan	54N	Lubricating Gauge Assy	89N	Exhaust valve rocker combination washer
20N	flywheel assy	55	Bolt	90	
21	oil seal	56N	Air Filter Cover	91N	Air intake door rocker combination
22N	Dual-head bolts	57N	Foam filter	93	Spring Coil of Intake Valve
23	Bolt	58N	Vent groove cover plate	94N	valve spring
24N	main bracket of fuel tank	59N	An air filter base.	95	oil seal assy
25	Bolt	60N	waste pipe	96	spark plug
26	Bolt	61	Air filter paper pad	97	Self-locking nut
27N	detent assy.	62N	Carburetor	98N	muffler cover assy.
28N	Pull Spring for Pull Rod	63	prime button II	99N	muffler assy.
29N	Handspike of Valve	64	Carburetor paper pad II	100	Muffler insulating pad
30	rate-limiting rocker arm shaft	65	Air Inlet Pipe	101N	wind shield
31	Gasket	66	Carburetor paper pad I	102N	Respirator valve plate
32	oil seal	67N	Dual-head bolts	103N	Respirator head gasket
33	R type pin	68N	Piston Ring I	104N	Valve rocker shaft
34	bolt	69N	Piston Ring II	105N	Ignition assy.
35N	throttle rocker arm	70N	Guide Rail	106	Bolt

UK-ST20210909