

Sturm!

POWER • GAS • HAND • TOOLS

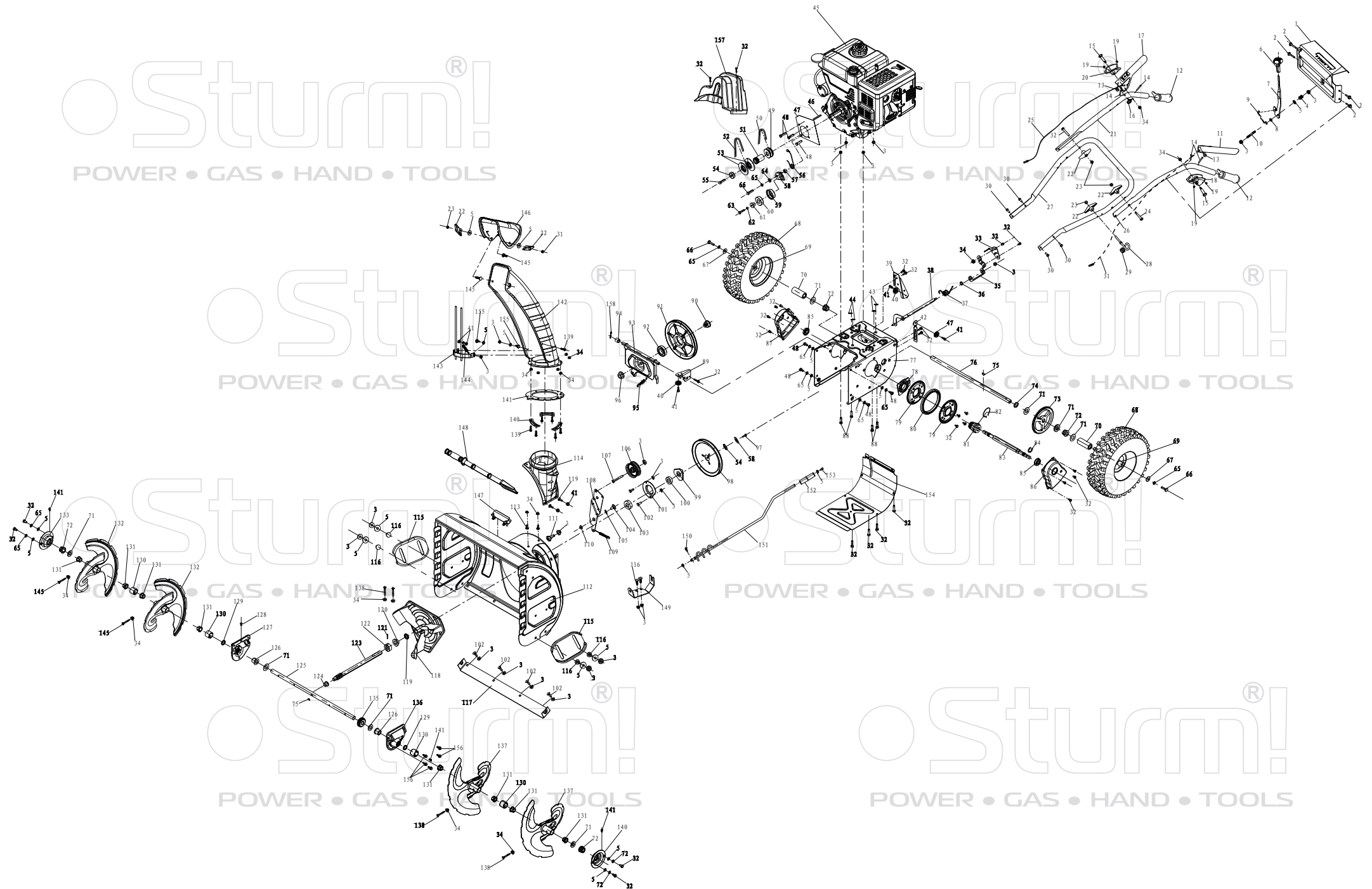

## STG5965 STG5965E

NO.	DESCRIPTION	NO.	DESCRIPTION	NO.	DESCRIPTION	NO.	DESCRIPTION	NO.	DESCRIPTION
1	Control panel	33	Shift plate	65	Washer	97	Hexagonal bolt	129	Oil seal
2	Hexagonal screw	34	Locking nut	66	Hexagonal screw	98	Driven pulley B	130	Spacer bushing
3	Hexagonal nut	35	Pressure Plate	67	Plain washer	99	Fixed base	131	Bushing
4	Spring	36	Split washer	68	Tyre	100	Spacer bushing	132	Right Auger
5	Plain washer	37	Spring	69	Wheel assembly	101	Pressure Plate	133	Bearing cover
6	Hand lever	38	Shift shaft assembly	70	Bushing	102	Bolt	134	Oil cup
7	Gear shift control arm	39	Clutch cable clamp A	71	Plain washer	103	Bearing	135	Worm gear
8	Hexagonal nut	40	Cable wheel	72	Shaft sleeve	104	Bolt-shaft	136	Left worm box
9	Gear shift cable	41	Bolt-shaft	73	Big gear	105	Washer	137	Right Auger
10	Bolt-shaft	42	Clutch cable clamp B	74	Split washer	106	Tension wheel B	138	Pin
11	Snow throwing control handle	43	Big cushion	75	Key	107	Hexagonal bolt	139	Hexagonal bolt
12	Handle	44	Small cushion	76	Axle	108	Install panel	140	Chute press board
13	Washer	45	Engine	77	Gearbox cover	109	Spring	141	Chute gasket
14	Screw	46	Flat key	78	Slide plate	110	Hexagonal nut	142	Chute
15	Bolt-shaft	47	Engine partition	79	Fixed plate	111	Screw	143	Discharge chute accessories
16	Spring	48	Hexagonal screw	80	Friction pulley	112	Snow bucket assembly	144	Spring
17	Walking control handle	49	Main pulley A	81	Slide bushing	113	Bolt	145	Bolt
18	Left handle bracket	50	Belt A	82	Washer	114	Chute base	146	Guide chute
19	Locking nut	51	Pulley bushing	83	Hexagon gear-shaft	115	Skid runner	147	Shavel base
20	Right handle bracket	52	Belt B	84	Split washer	116	Bolt	148	Plastic shavel
21	Right Handrail	53	Main pulley B	85	Bearing	117	Shave plate	149	Support panel
22	Locking handle	54	Plain washer	86	Left mounting base	118	Fan	150	Cotter pin
23	Locking nut	55	Hexagonal bolt	87	Right mounting base	119	Oil seal	151	Snow ejection adjusting crank
24	Bolt	56	Spring	88	Hexagonal bolt	120	Rear supporting base	152	Handle sleeve
25	Clutch cable	57	Bushing	89	Fixed plate	121	Pin	153	Cross recessed round head screw
26	Left Handrail	58	Install panel	90	Fixed shaft	122	Locating sleeve	154	Gear box plate
27	Handrail frame	59	Tension wheel A	91	Driven pulley A	123	Drive worm shaft	155	Bolt
28	Bolt	60	Bearing	92	Bearing	124	Front supporting base	156	Hexagonal bolt
29	Buffer ring	61	Bushing	93	Fixed plate assembly	125	Output shaft	157	Belt cover
30	Hexagonal bolt	62	Washer	94	Bushing	126	Slide bearing	158	Cotter pin
31	Clutch cable B	63	Hexagonal bolt	95	Spring	127	Right worm box		
32	Hexagonal screw	64	Bushing	96	Hexagonal nut	128	Plastic plug		