

TC9820U

NO.	DESCRIPTION	NO.	DESCRIPTION
1	WATER TANK	39	609ZZ ANTI-DUST BEARING
2	RIGHT TABLE	40	PREJUDICIAL ARBOR
3	LEFT TABLE	41	HANDLE
4	FRONT/REAR SUPPORT BOARD	42	M6X15 PAN HEAD SCREW
5	FRONT/REAR SCALE BOARD	43	DJ-800W MOTOR
6	M5X20 SUNK HEAD SCREW	44	WIRE SLEEVE
7	M6X15 HEX. SCREW	45	INNER NUT
8	Ø 6 FLAT WASHER	46	CONNECTOR FOR NUT
9	FRONT/REAR SCALE PLATE	47	OUTER NUT
10	POINTER	48	ANTI-KINK DEVICE
11	KNOB	49	RUBBER SEAL
12	M6X18 BOLT WITH STAR SURFACE	50	POWER BOX BASE
13	M6X12 HEX. BOLT	51	SWITCH
14	BASE FOR ANGLE RULER	52	GRIP PLATE
15	SLIDING SCREW NUT	53	SEAL FOR MAIN CONTROL BOX
16	LEFT FENCE	54	3.5X16 SELF-TAPPING SCREW
17	SCALE PLATE	55	COVER FOR POWER BOX
18	ANTI-DUST COVER	56	2.9X18 SELF-TAPPING SCREW
19	FIXING RING	57	M5X15 PAN HEAD SCREW
20	RUBBER WASHER	58	GROUNDING SYMBOL
21	KNOB FOR ANGLE RULER	59	12.5MF CAPACITOR
22	M6X25 BOLT WITH STAR SURFACE	60	CLIP FOR CAPACITOR
23	RIGHT FENCE	61	3.5X12 SELF-TAPPING SCREW
24	M5X25 PAN HEAD SCREW	62	2.9X16 SELF-TAPPING SCREW
25	SAFE GUARD	63	TERMINAL BLOCK
26	M12 LH SCREW	64	PLUG + CORD
27	OUTER FLANGE	65	M6 PAPILIONACEOUS SREW NUT
28	SLIDING RAIL	66	SPLINY FOR PTOTRVTIVE-WATER BOAR
29	Ø 230 DIAMOND DISC	67	WATER SPLASH BOARD
30	INNER FLANGE	68	Ø6 FLAT WASHER
31	FIXING SAFE GUARD	69	SHIELD PLATE
32	M8 NYLON LOCK NUT	70	Ø5 TEETH-WASHER
33	Ø8 FLAT WASHER	71	PUMP
34	M5X15 HEX. SCREW	72	M5X15 PAN HEAD SCREW
35	Ø5 FLAT WASHER	73	Ø5 FLAT WASHER
36	Ø5 SPRING WASHER	74	Ø5 SPRING WASHER
37	POSITION PLATE	75	MOTOR SUPPORT
38	Ø9 protective ring for arbor	76	

TC9820U

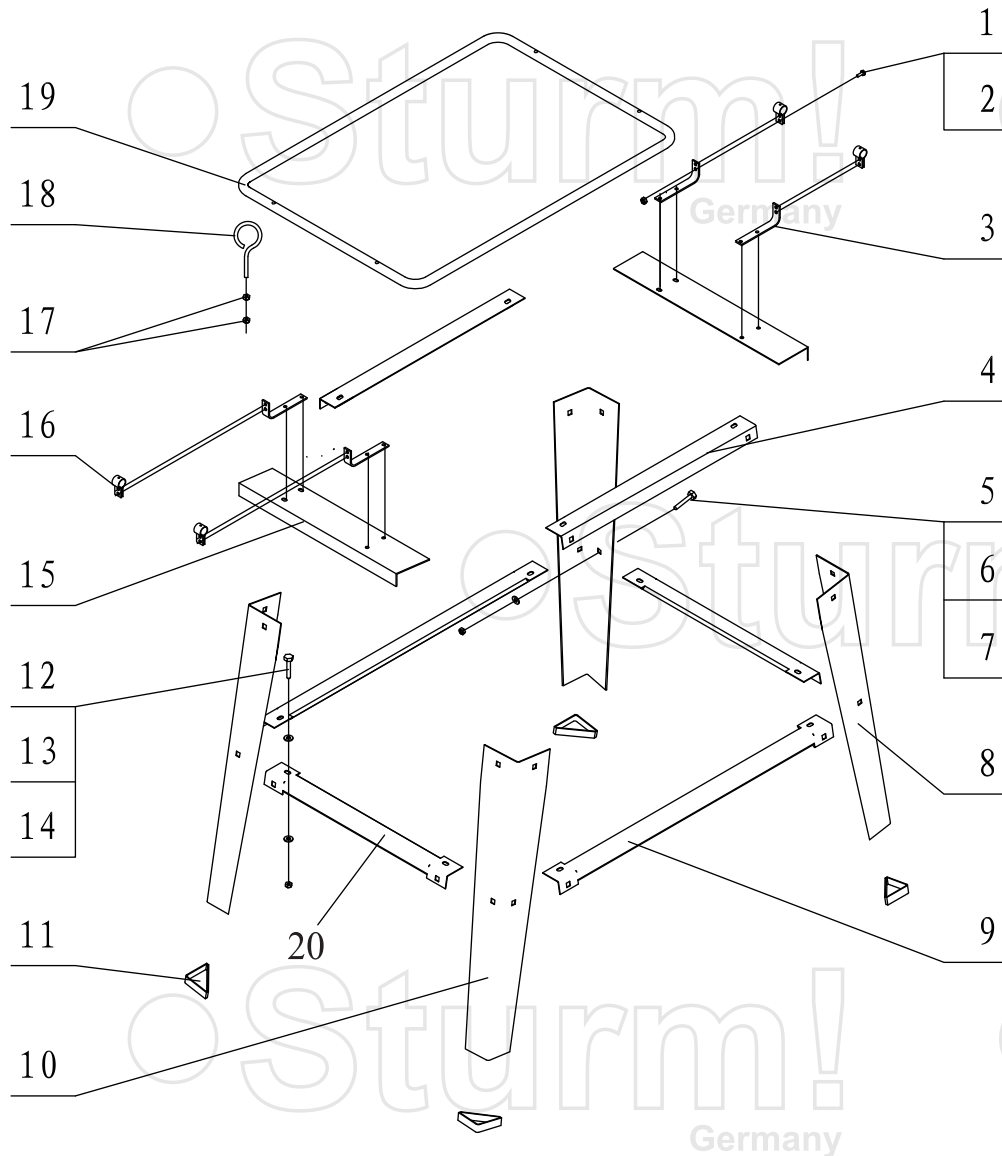

NO.	DESCRIPTION
1	M5X10 HEX. SCREW
2	M5 NYLON LOCKED-SCREW NUT
3	CONNECTING BOARD
4	LONG BRACE (UP)
5	M8X16 SQUARE NECK SCREW
6	F8 FLAT WASHER
7	M8 NYLON LOCKED-SCREW
8	SUPPORT LEG LEFT
9	LONG BRACE
10	SUPPORT LEG RIGHT
11	FOOT SLEEVE
12	M6X15 HEX. SCREW
13	Ø6 FLAT WASHER
14	M6 NYLON LOCKED-SCREW NUT
15	SHOUT BRACE (UP)
16	POSITIONING CLIP
17	M5 SCREW NUT
18	BLOCK LINK
19	WATER TANK BLOCK LINK
20	SHORT BRACE

RU5120901