

POWER • GAS • HAND • TOOLS

POWER • GAS • HAND • TOOLS

POWER • GAS • HAND • TOOLS

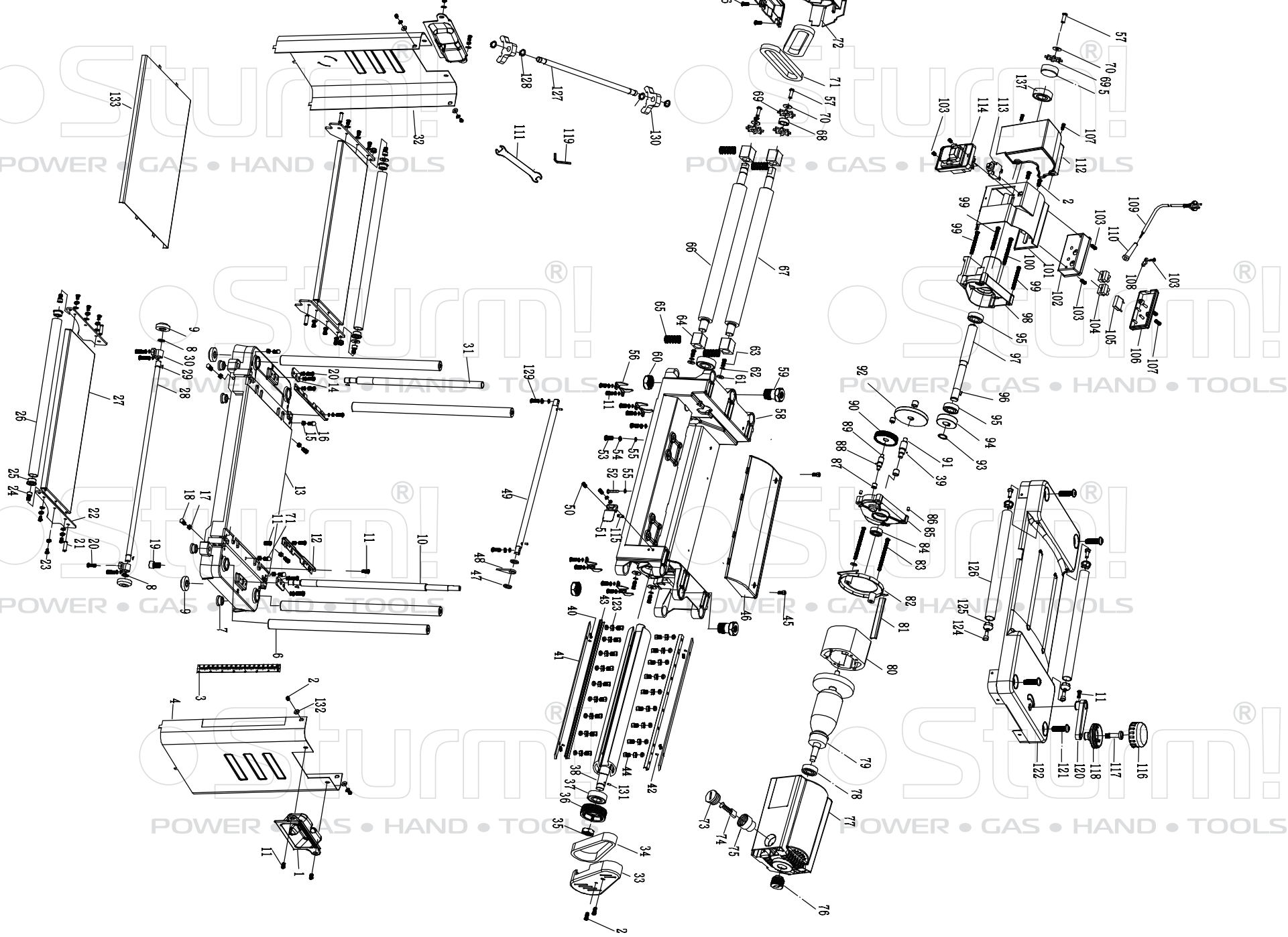

TH1433

NO.	DESCRIPTION	NO.	DESCRIPTION	NO.	DESCRIPTION
1	HANDLE	48	RECOIL CLAW	97	OUTPUT SHAFT
2	CROSS PAN HEAD SCREW	49	BOUNCE-BACK AXIS	98	GEAR BOX
3	STAFF GAUGE	50	CROSS PAN HEAD TAPPING SCREW	99	CROSS PAN HEAD TAPPING SCREW
4	RIGHT BOARD COVER	51	POINTER	100	CROSS PAN HEAD TAPPING SCREW
5	SHAFT SLEEVE 1	52	CROSS PAN HEAD TAPPING SCREW	101	BACK COVER
6	GUIDE ROD	53	INNER HEXAGON SCREW	102	CONNECTION SEAT
7	RUBBER FEET	54	SPRING WASHER	103	CROSS PAN HEAD TAPPING SCREW
8	ELASTIC CIRCLIP	55	FLAT WASHER	104	AMPHENOL CONNECTOR
9	BEVEL GEAR	56	BEARING PRESS PLATE	105	CAPACITANCE
10	RIGHT LEAD SCREW	57	INNER HEXAGON SCREW	106	JUNCTION BOX
11	CROSS RECESS PAN HEAD SCREW	58	ENGINE BODY	107	CROSS PAN HEAD TAPPING SCREW
12	ORIENTATION PLANK	59	NON-STANDARD NUT	108	TENSION DISC
13	BASE PLATE	60	HEX NUT	109	CABLE
14	SCREW CLAMP	61	FLAT WASHER	110	CABLE SHEATH
15	HEX NUT	62	ECTERNAL TOOTH WASHER	111	OPEN SPANNER
16	HEXAGON BOLT	63	CROSS RECESSED COUNTERSUNK HEAD SCREW	112	BACK COVER END PLATE
17	HEX NUT	64	SQUARE BEARING	113	OVERCURRENT PROTECTIVE DEVICE
18	HEXAGON BOLT	65	PRESSURE SPRING 1	114	SWITCH
19	INNER HEXAGON SCREW	66	IRON ROLLER	115	POINTER WASHER
20	CROSS PAN HEAD TAPPING SCREW	67	POLY ANN ACYL	116	HANDLE COVER
21	ELASTIC CYLINDRICAL PIN	67-1	ROLLER SHAFT	117	HANDLE SCREWS
22	SUPOORT FEET	68	ADJUSTING SLEEVE	118	HAND SHANK
23	CROSS PAN HEAD TAPPING SCREW	69	CHAIN WHEEL 1	119	BELT COVER
24	INNER HEXAGON SCREW	70	BIG FLAT WASHER	120	ROCKER
25	PLUG	71	CHAIN	121	NON-STANDARD SOCKET HEAD CAP SCREW
26	ROLL POLE	72	THICK FLAT MAT	122	UPPER COVER PLATECOMPONENTS
27	EXTENSION PLATE	73	CARBON BRUSH HOLDER COVER	122-1	UPPER COVER PLATE
28	RAIL	74	CARBON BRUSH	122-2	COVER PLATE WELDED
29	WOODRUFF KEY	75	CARBON BRUSH HOLDER	123	SQUARE NUT
30	RAIL BEARING	76	SMALL PULLEY	124	PIN
31	LEFT LEAD SCREW	77	MAIN CASE	125	PLUG 1
32	LEFT BOARD COVER	78	BEARING 6201	126	ROLLER ROD 1
33	BELT COVER	79	ARMATURE	127	KNIFE GAUGE SHAFT
34	PJ RIBBED BELT	80	STATOR	128	ELASTIC COLLAR
35	THIN NUT	81	WIRE JACKET	129	CROSS PAN HEAD TAPPING SCREW
36	BIG RUNNING WHEEL	82	BREAK WIND RING	130	ELASTIC CYLINDRICAL PIN
37	BEARING 6203	83	CROSS PAN HEAD TAPPING SCREW	131	CYLINDRICAL PIN
38	KNIFE SHAFT	84	BEARING 6200	132	THICK FLAT MAT
38-1	KNIFE SHAFT 1	85	MIDDLE COVER	133	PANEL
38-2	KNIFE SHAFT 2	86	LOCATION SLEEVE	134	CHAIN COVER PROTECT PLATE
38-3	KNIFE SHAFT BODY	87	0608 ROLLER PIN	135	CROSS PAN HEAD TAPPING SCREW
39	STEEL BALL	88	STEEL BALL	136	CROSS COUNTERSUNK HEAD SCREW
40	PRESSURE SPRING 4	89	GEAR SHAFT1	137	DEEP GROOVE BALL BEARING
41	KNIFE BLADE	90	BEVEL GEAR 1		
42	ELASTIC CYLINDRICAL PIN	91	GEAR SHAFT 2		
43	PRESS PLANK	92	GEAR 1		
44	OUTER HEXAGON SCREW	93	ELASTIC CIRCLIP		
45	INNER HEXAGON SCREW	94	GEAR 2		
46	DUST COVER	95	BEARING 6002		
47	WASHER	96	WOODRUFF KEY		

UK20210415